

GALASSI&ORTOLANI

VALVESMANUFACTUREDIVISION

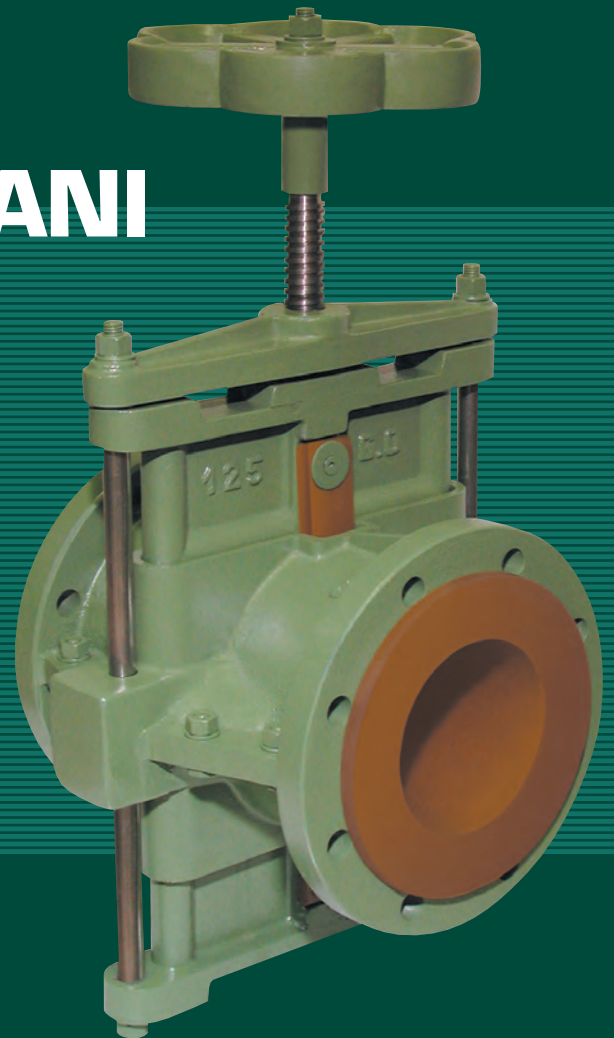

PINCHVALVES

BUTTERFLYVALVES

DIAPHRAGMVALVES

CHECKVALVES

BALLVALVES

GATEVALVES

THERMOPLASTICVALVES

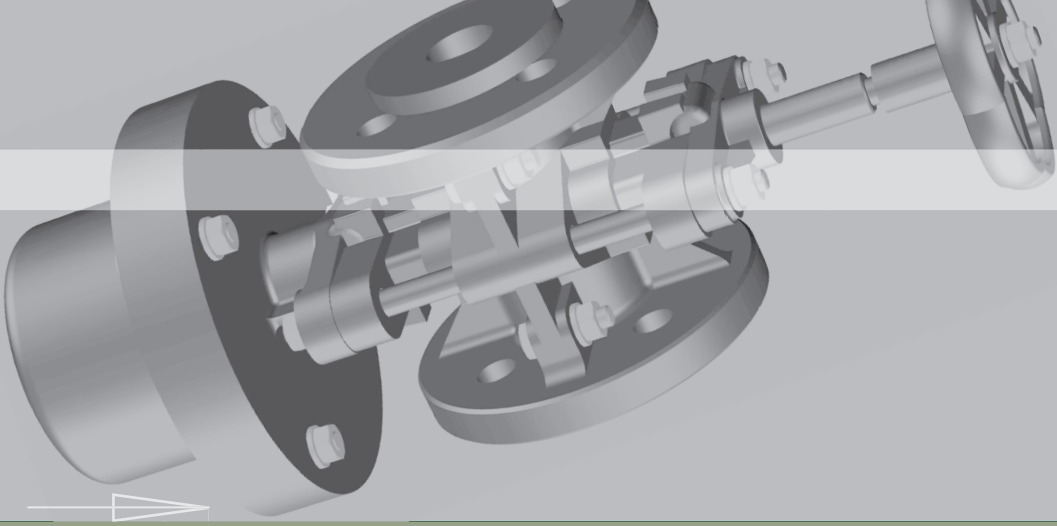

PI

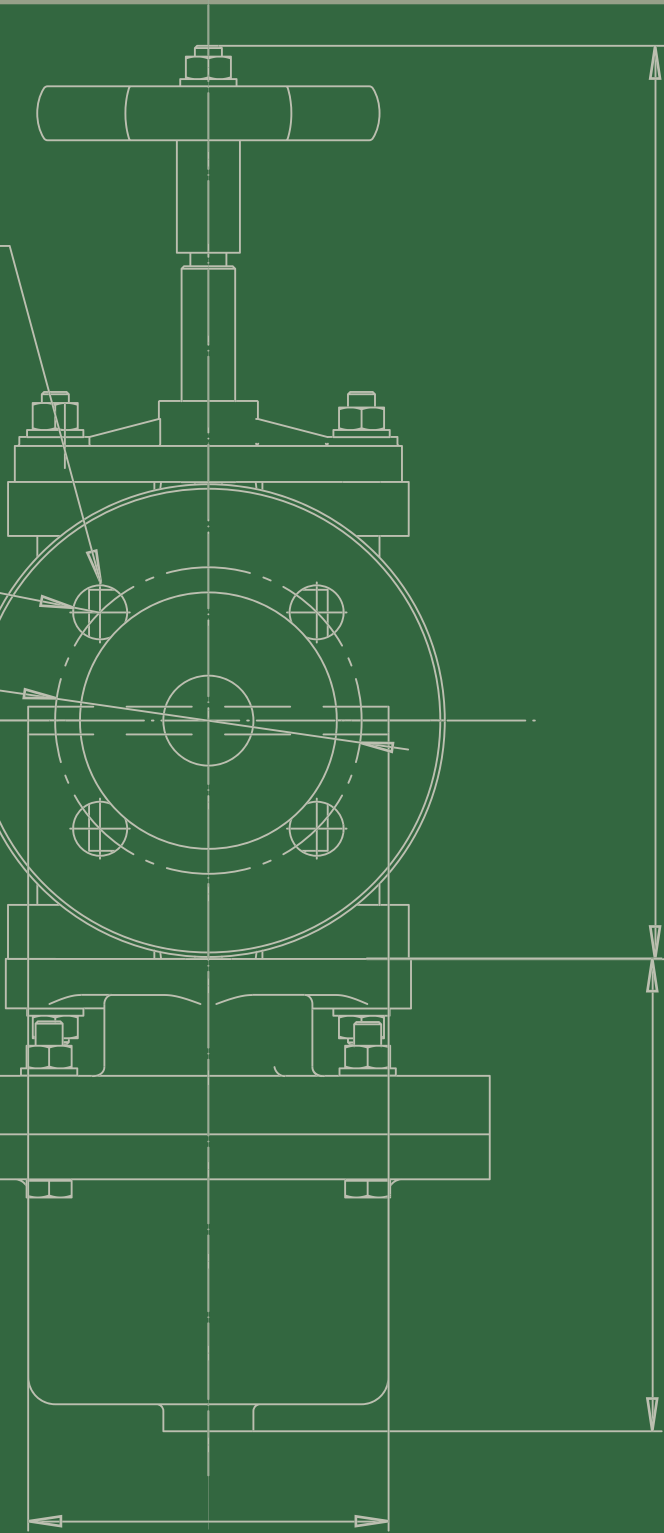

NCH VALVES

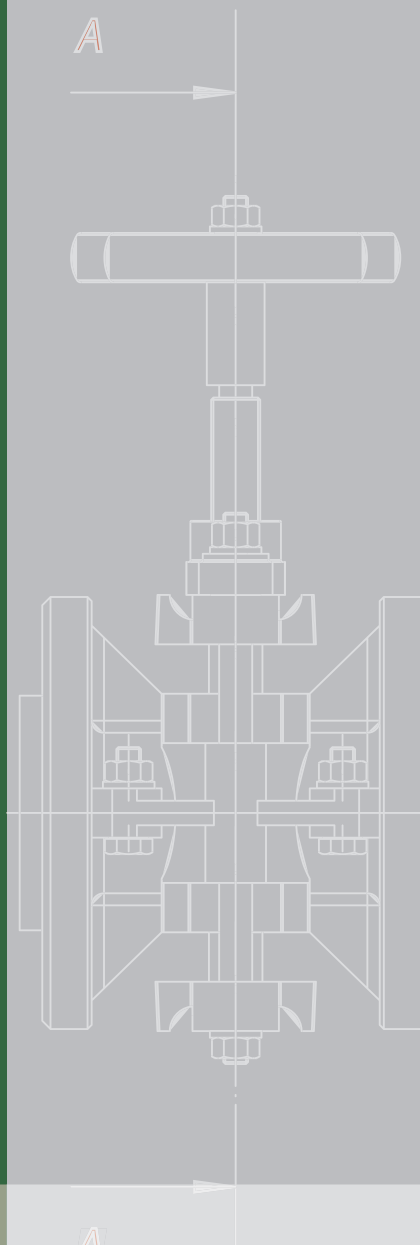
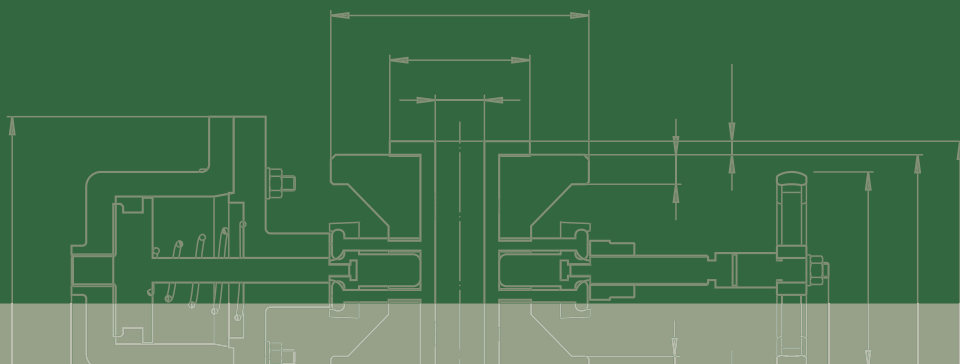

THE ANSWER TO PROBLEMS OF: CORROSION, ABRASION, GRANULATED MATERIALS, POWDERS, SLUDGE, GAS ETC.

Hand and pneumatic operated pinch valves do not incorporate any stuffing box and are leaktight on all liquids, slurries, granular materials, powders, pastes, gases, acids etc..

Sleeve (internal rubber) is supported during opening and closing, and is easily replaceable without any special tools. The wide range of available elastomer materials enables an appropriate selection for each application and is a guarantee of perfect resistance to corrosion and abrasion.

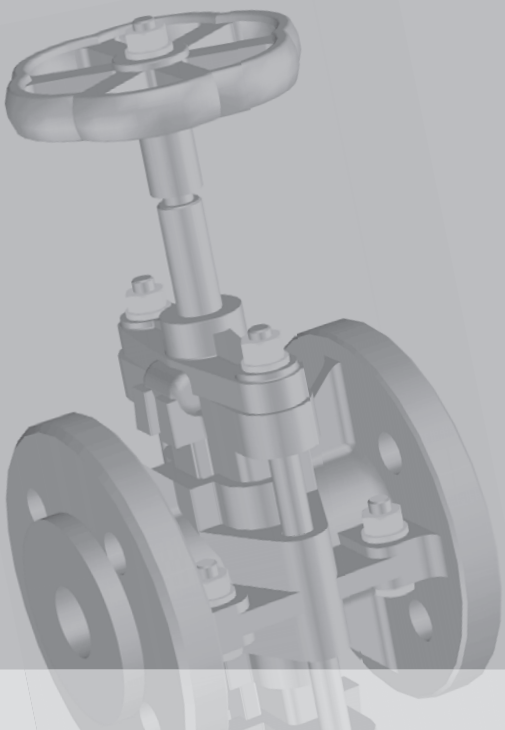

PRODUCT FEATURES

- Straight through way
- Sized from ½" through 14"
- Flanged valves in according to UNI PN 10 and ANSI/ASME 150#
- Manual, pneumatic and electric operators

PERFORMANCE FEATURES

- No loss of head
- Faultless sealing on liquids, fluid suspensions, granulated materials, powders, sludge, gas, etc.
- No packing
- Quick and easy replacement of sleeve, no special tooling required
- Sleeve supported during opening and closing: hence the possibility of under vacuum operation
- No maintenance
- Long durability
- Threaded spindles and side tie rods in stainless steel
- Cylinders in aluminium and specially treated cylinder springs on pneumatic models
- Epoxy painted, valve bodies protected with an anti-acid varnish

BODY VALVE MATERIALS

- Cast iron GG25/Cast iron A126
- Spheroidal cast iron GGG40/Ductil iron ASTM A 395
- Pure aluminium
- Cast steel A 216 grade WCB
- Cast steel A 352 grade LCB
- 316 Stainless steel ASTM A 351 grade CF3M
- 316 L Stainless steel ASTM A 351 grade CF8M

MATERIAL OF SLEEVES

- Natural rubber
- White natural rubber
- Neoprene
- EPDM
- Viton
- Butyl
- Nitrile
- Hypalon
- Silicone
- Neoprene/Silicon (mixed)

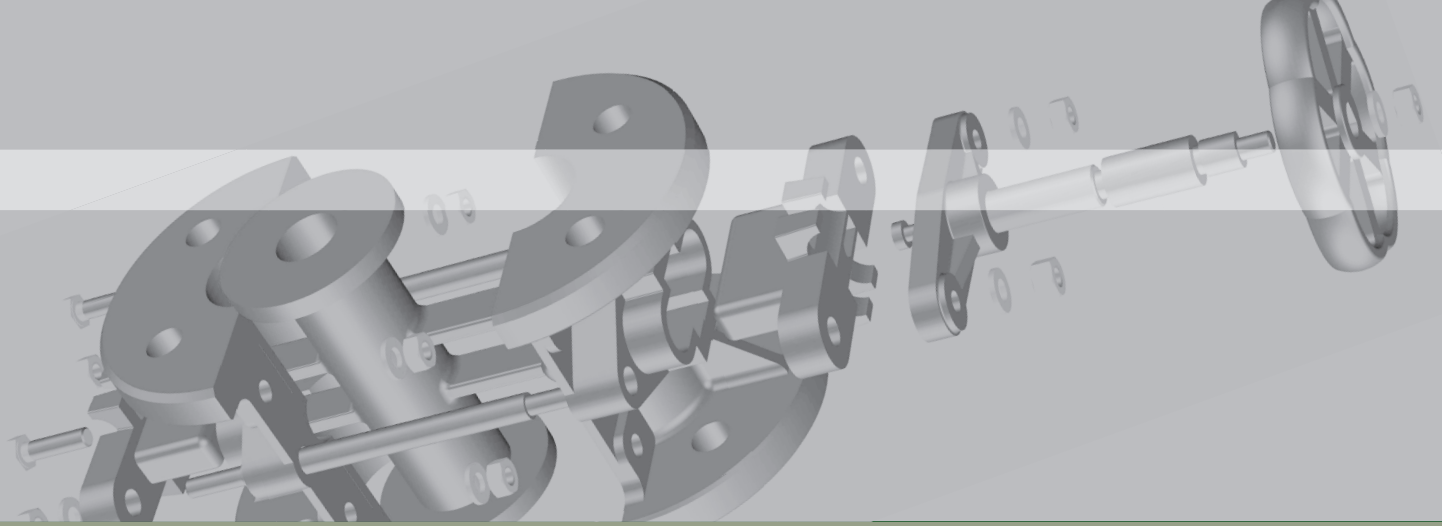

CERTIFICATES AVAILABLE

- EN 10204 3.1.B
- EN 10204 2.2
- GHOST-R

INSPECTION TESTS AVAILABLE BY

- SGS GLOBAL TRADE SOLUTIONS
- ITS INTERTEK TESTING SERVICES
- BV BUREAU VERITAS

MAIOR MARKETS SERVED

- Chemical process
- Power generation
- Water treatment
- Mining
- Pulp & Paper
- Nuclear
- Pharmaceutical
- Food & Beverage
- Sugar

OPTIONS

- Limit switches
- Solenoid valve
- Position indicator
- Air filter regulator
- 3:15 PSI positioner
- 4:20mA electropneumatic positioner or 4:20mA electronic transmitter of position 30°-90°angle
- Triphase AC motor

G&O SERIES PNEUMATIC ACTUATORS

Piston type air operators line offer a great solution to a wide range of actuation situations. They are exclusively designed to G&O series pinch valves and can be mounted in any position. These actuators are built in aluminium and are available in three options:

- single effect acting - fail to close (air to open)
- single effect acting - fail to open (air to close)
- double effect acting - fail to open & fail to close

Single effect acting actuators are fitted by an extractable handwheel for security.

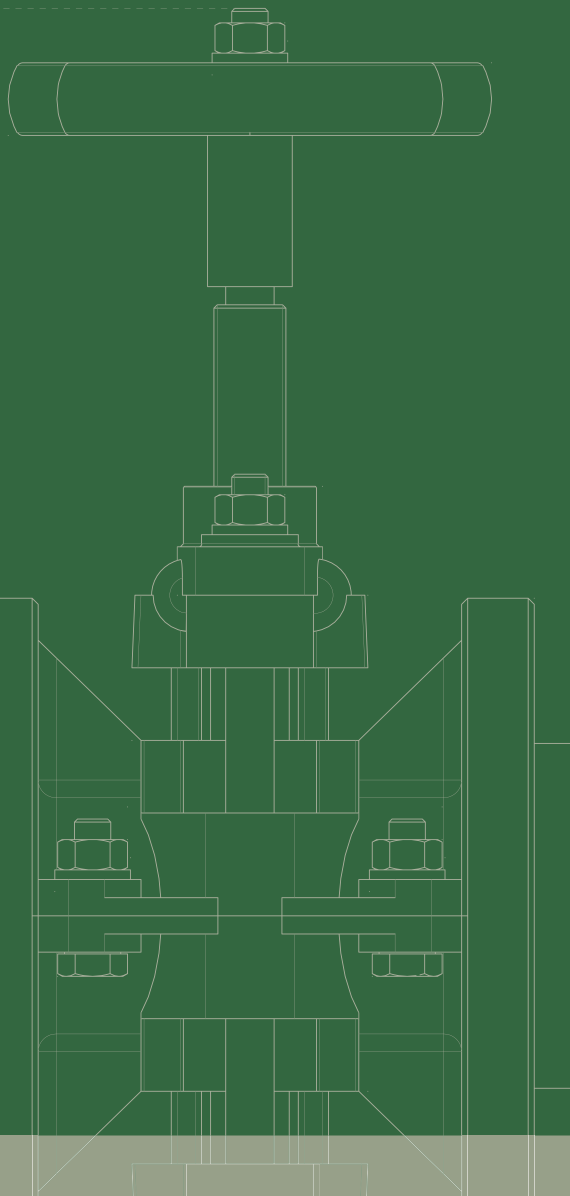

Model GS1

PINCH VALVES

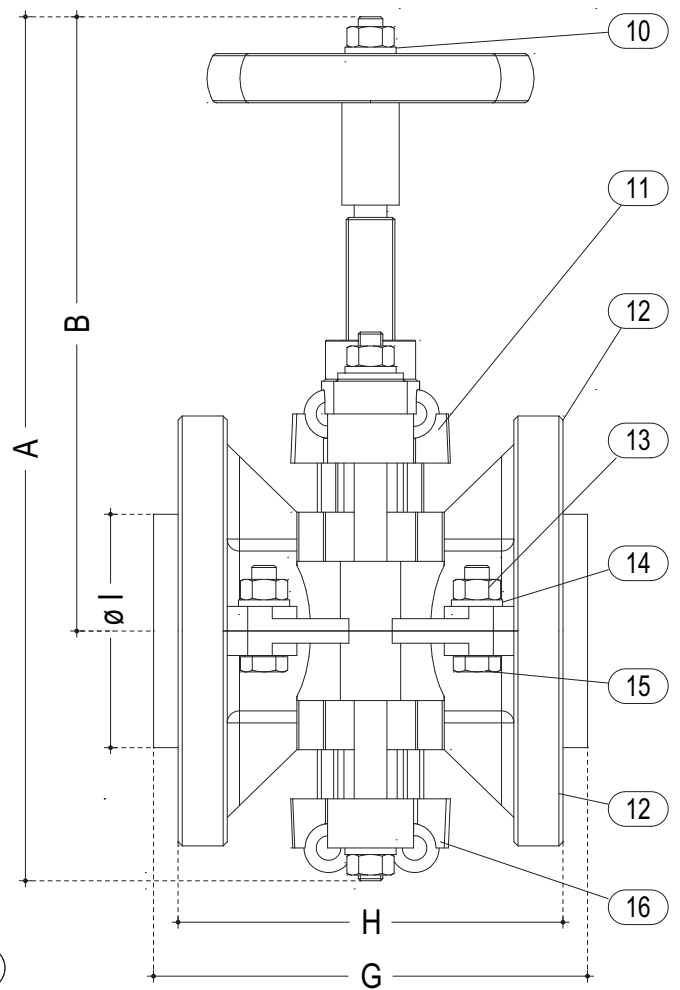
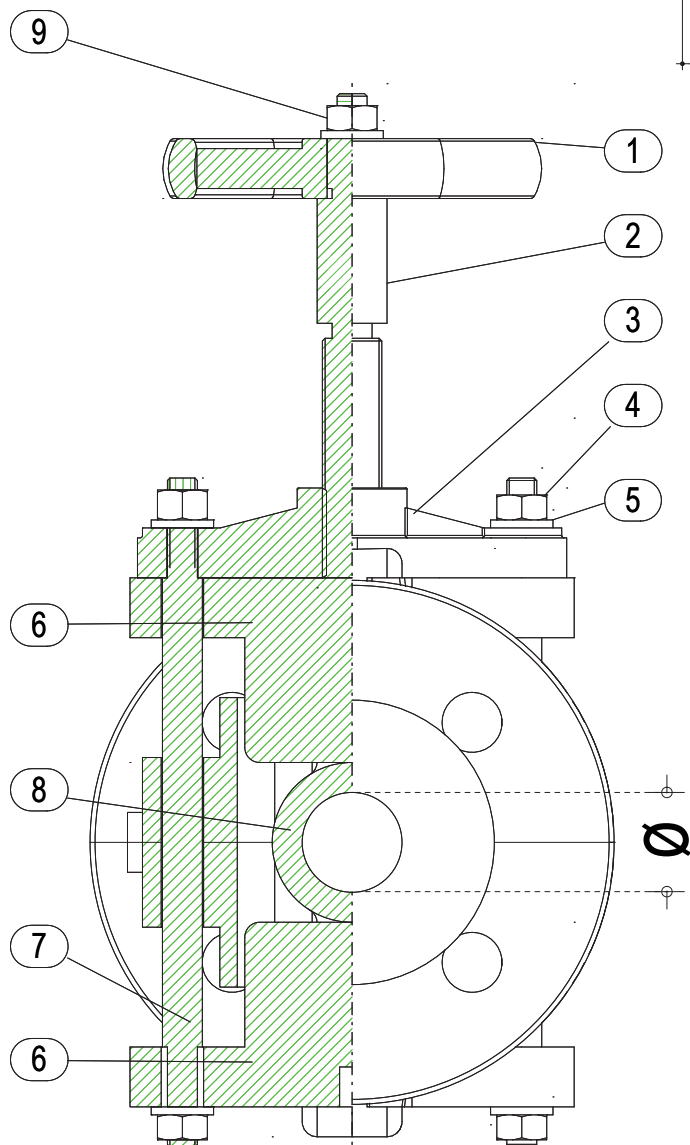

DETAILS

1	WHEEL
2	LEAD SCREW
3	SUPPORT
4	HEXAGON NUT
5	WASHER
6	PLUG
7	TIE ROD
8	RUBBER SLEEVE
9	HEXAGON NUT
10	WASHER
11	UPPER RETURN BUSHING BRONZE
12	VALVE BODY
13	HEXAGON NUT
14	WASHER
15	HEXAGON BOLT
16	LOWER RETURN BUSHING

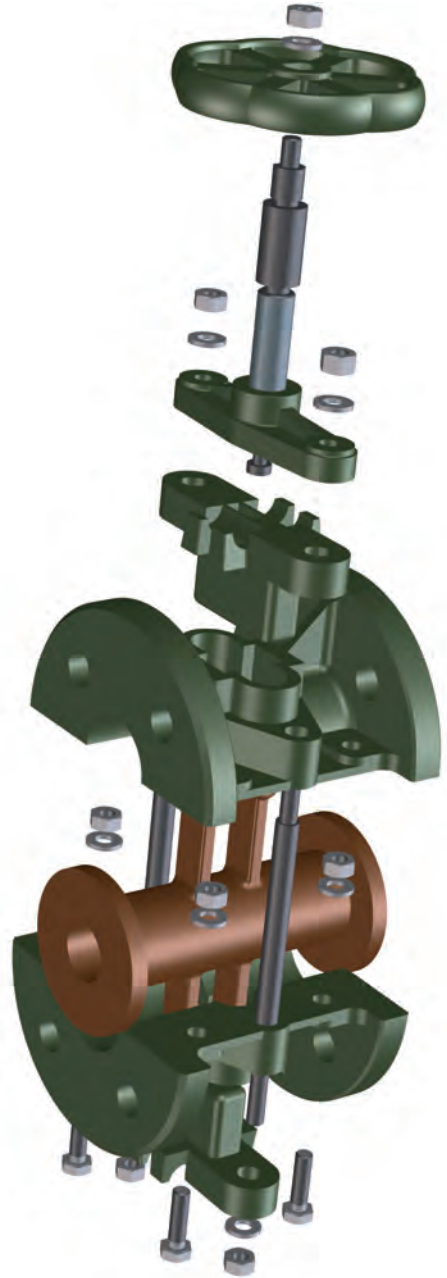
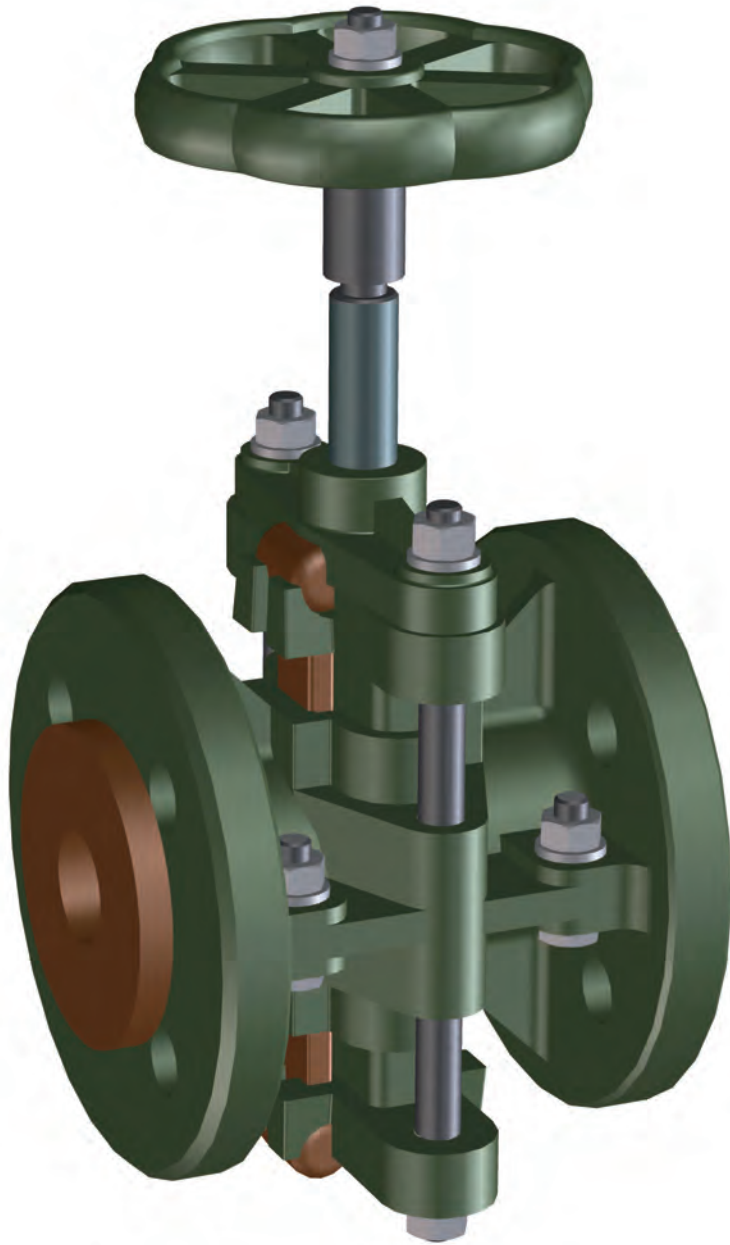

PRESSURE DETAILS UNI_1284

DN	P.N.	HYDRAULIC TEST kg/cm ²		WORKING PRESSURE kg/cm ²
		OPEN	CLOSE	
10	5	10	5	4
15	5	10	5	4
20	5	10	5	4
25	5	10	5	4
30	5	10	5	4
40	5	10	5	4
50	5	10	5	4
60	5	10	5	4
70	5	10	5	4
80	5	10	5	3
90	5	10	5	3
100	4	10	4	3
125	4	10	4	3
150	4	8	4	3
175	4	8	4	3
200	4	8	4	3

WEIGHT KG

ALUMINIUM	C.I.
0,600	1,000
0,800	1,500
1,300	3,000
1,800	3,600
2,800	5,600
4,000	8,000
5,000	10,300
6,500	13,600
7,600	15,000
9,200	18,000
15,000	28,000
14,500	26,600
22,000	40,000
27,000	51,000
37,000	67,000
41,400	72,000

DIMENSIONS

Ø	A	B	G	H	I
10	145	100	73	65	50
15	165	115	92	80	50
20	210	150	107	95	58
25	230	160	118	106	60
30	255	178	130	115	78
40	305	212	154	140	88
50	335	233	176	160	102
60	355	245	194	180	130
70	390	260	206	190	137
80	420	280	215	196	148
90	490	320	250	232	178
100	500	330	275	260	158
125	630	415	300	280	198
150	680	445	330	300	222
175	765	500	355	335	280
200	840	550	375	350	298

NOTE: For different pressure details please ask the DPT

Model GS2

PINCH VALVES

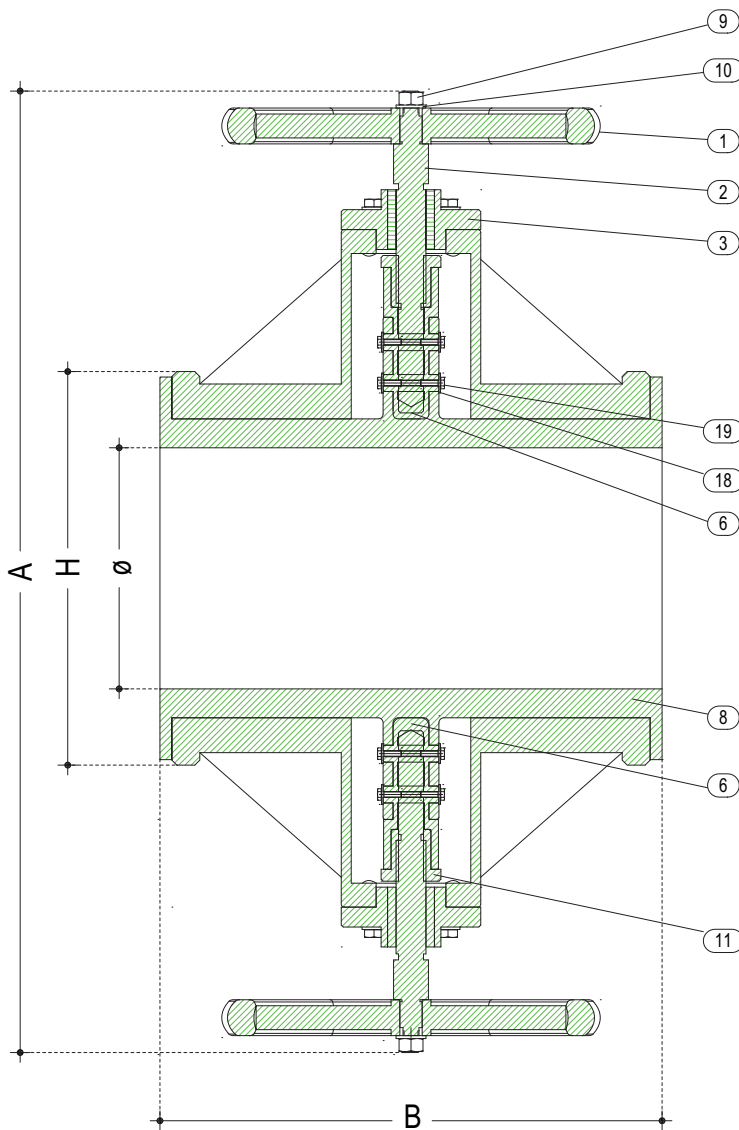
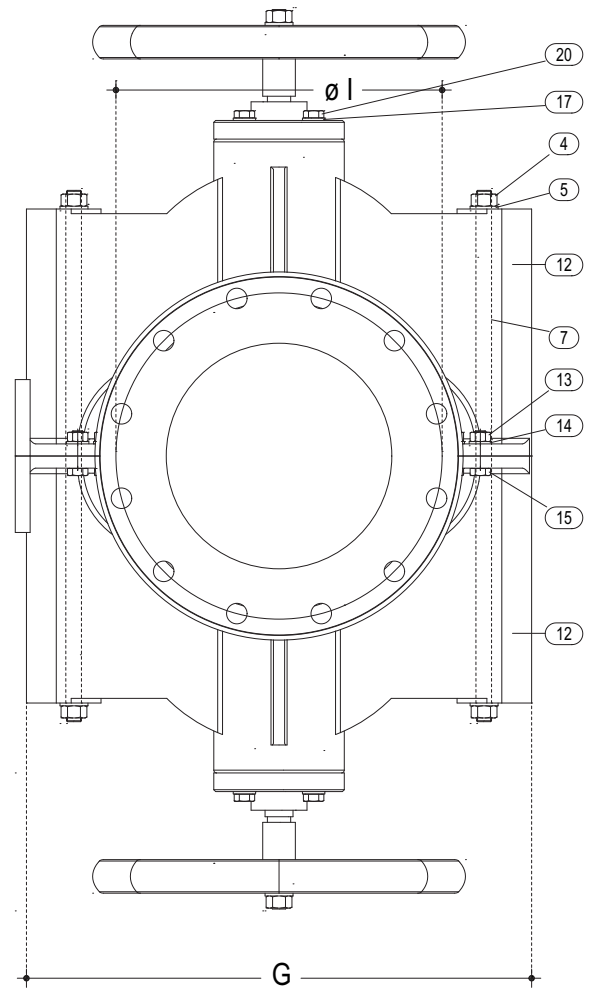

DETAILS	
1	WHEEL
2	LEAD SCREW
3	BUSHING
4	HEXAGON NUT
5	WASHER
6	PLUG
7	TIE ROD
8	RUBBER SLEEVE
9	HEXAGON NUT
10	WASHER
11	BUSHING
12	VALVE BODY
13	HEXAGON NUT
14	WASHER
15	HEXAGON BOLT
16	CLAMPING SCREW FOR BUSHING
17	WASHER
18	WASHER
19	CLAMPING SCREW FOR BUSHING
20	HEXAGON BOLT

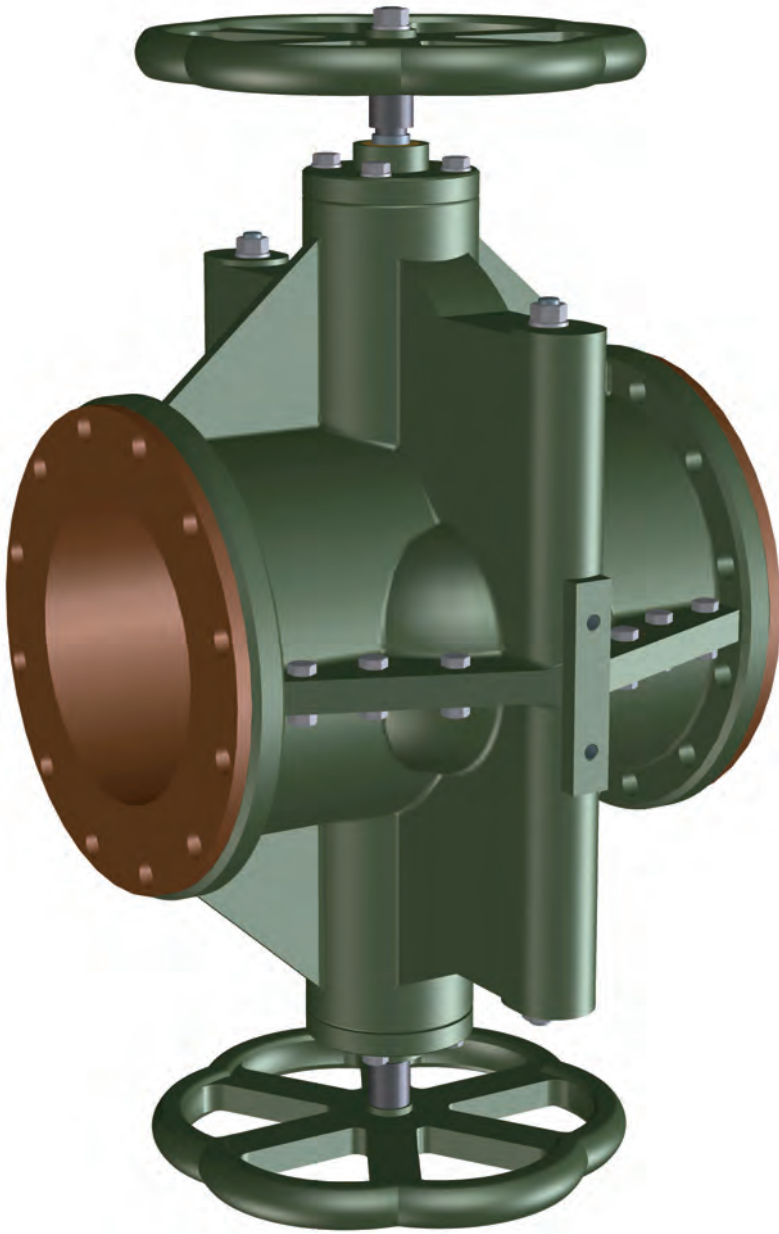

PRESSURE DETAILS UNI_1284

DN	P.N.	HYDRAULIC TEST kg/cm ²		WORKING PRESSURE kg/cm ²
		OPEN	CLOSE	
250	4	8	4	2,5
300	4	8	4	2,5
350	3,5	8	3,5	2

NOTE: For different pressure details please ask the DPT

WEIGHT KG

ALUMINIUM	C.I.
82,000	150,000
104,000	200,000
166,000	328,000

DIMENSIONS

Ø	A	B	G	H	I
250	1100	510	515	395	350
300	1200	600	605	445	400
350	1300	700	720	505	460

Model GS5

PINCH VALVES

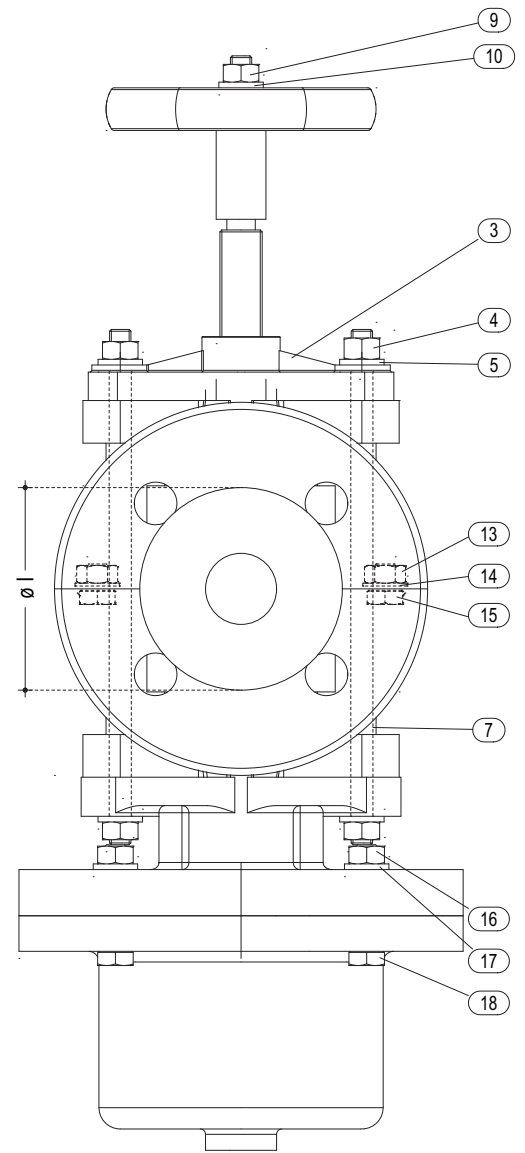
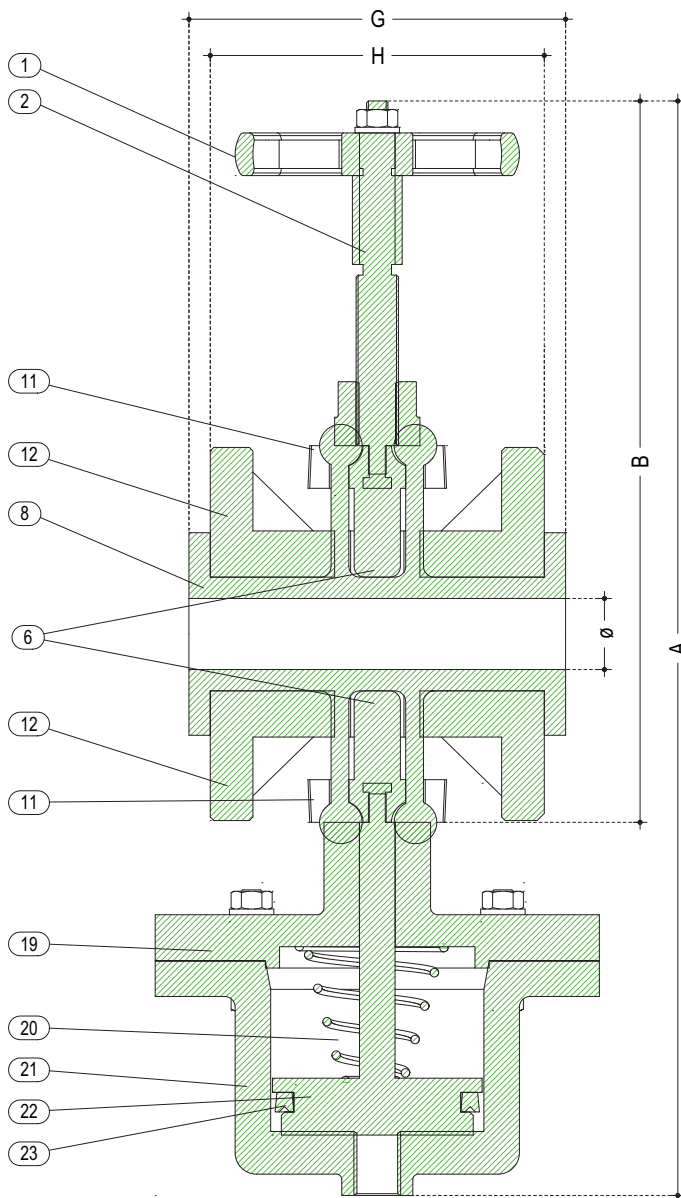

DETAILS

1	WHEEL
2	LEAD SCREW
3	SUPPORT
4	HEXAGON NUT
5	WASHER
6	PLUG
7	TIE ROD
8	RUBBER SLEEVE
9	HEXAGON NUT
10	WASHER
11	RETURN BUSHING BRONZE
12	VALVE BODY
13	HEXAGON NUT
14	WASHER
15	HEXAGON BOLT
16	HEXAGON NUT
17	WASHER
18	HEXAGON NUT
19	SUPPORT AND CYLINDER
20	SPRINGS
21	CYLINDER
22	PISTON AND DRIVE PIN
23	"V" GASKET
24	RUBBER TUBE

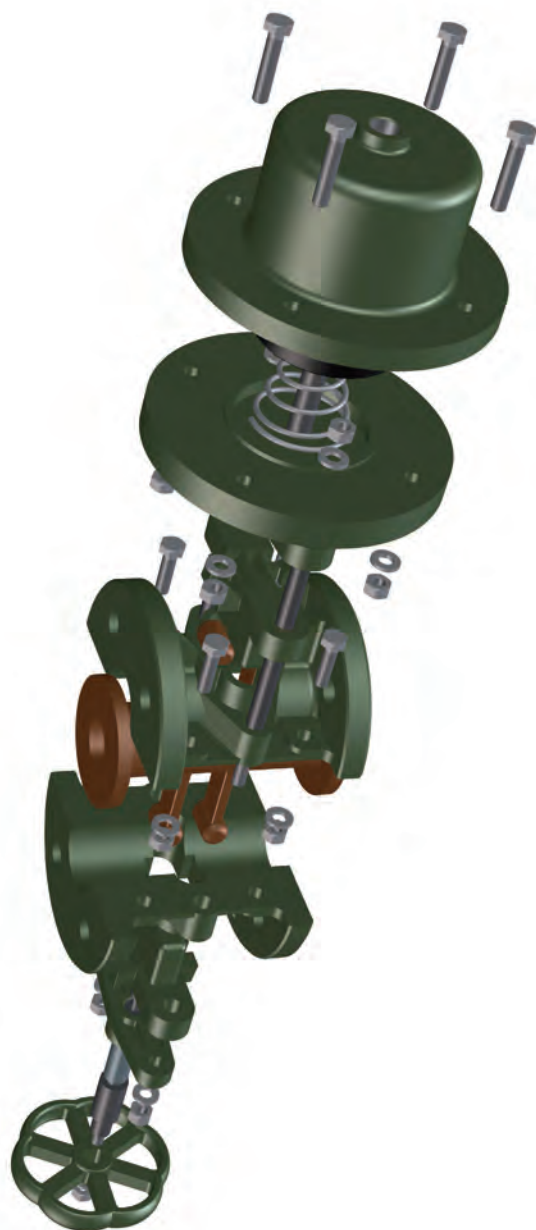
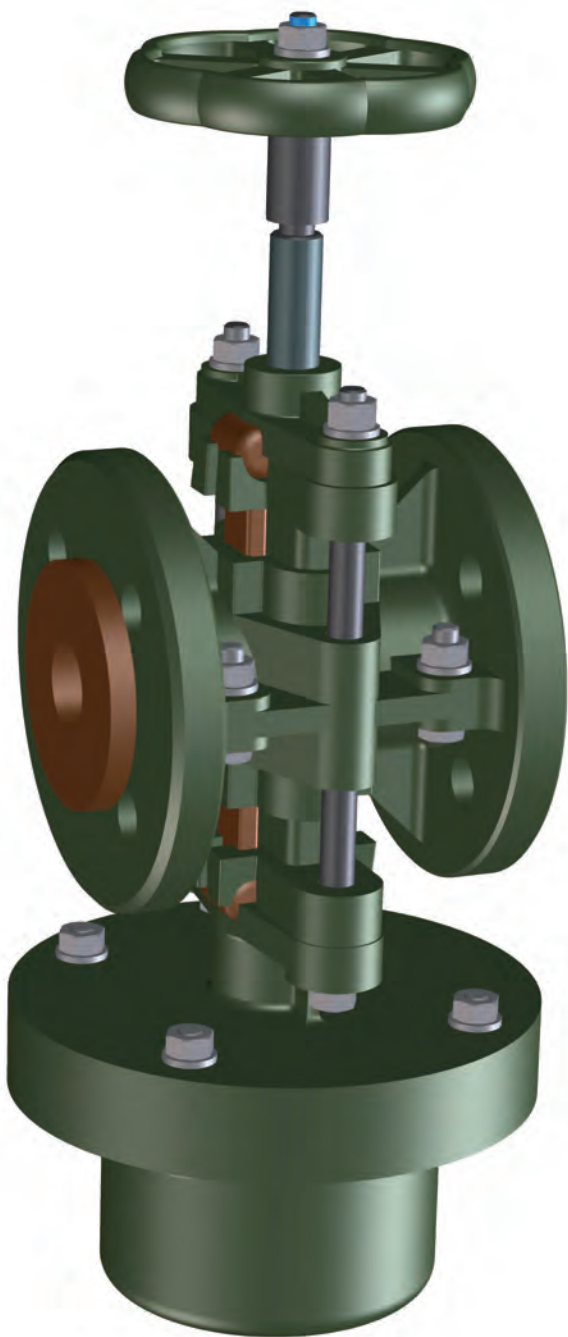

PRESSURE DETAILS UNI_1284

DN	P.N.	HYDRAULIC TEST kg/cm ²		WORKING PRESSURE kg/cm ²
		OPEN	CLOSE	
20	5	10	5	4
25	5	10	5	4
30	5	10	5	4
40	5	10	5	4
50	5	10	5	4
60	5	10	5	4
70	5	10	5	4
80	5	10	5	3
90	5	10	5	3
100	4	10	4	3
125	4	10	4	3
150	4	8	4	3
175	4	8	4	3
200	4	8	4	3

AIR PRESSURE REQUIRED KG/CM²

dn	20	25	30	40	50	60	70	80	90	100	125	150	175	200
min.	4	4	4	4	4	4	4	3,5	3,5	3,5	3,5	3,5	3,5	3,5
max.	6	6	6	5	5	5	5	4,5	4,5	4,5	4,5	4,5	4,5	4,5

WEIGHT KG

ALUMINIUM	C.I.
3,000	5,000
4,500	6,000
5,200	8,000
7,700	12,200
9,000	13,600
12,100	19,000
13,500	21,000
15,000	23,000
23,000	29,000
23,000	36,000
33,000	52,000
43,500	65,000
54,000	79,000
61,000	94,500

DIMENSIONS

Ø	A	B	G	H	I
20	310	205	107	95	58
25	345	220	118	106	68
30	380	245	130	115	78
40	445	300	154	140	88
50	495	330	176	160	102
60	525	350	194	180	130
70	565	280	206	190	137
80	605	410	215	196	148
90	665	450	250	232	178
100	715	490	275	260	158
125	850	600	300	280	198
150	935	650	330	300	222
175	1055	740	355	335	280
200	1142	800	375	350	298

NOTE: For different pressure details please ask the DPT

Model GS5D

PINCH VALVES

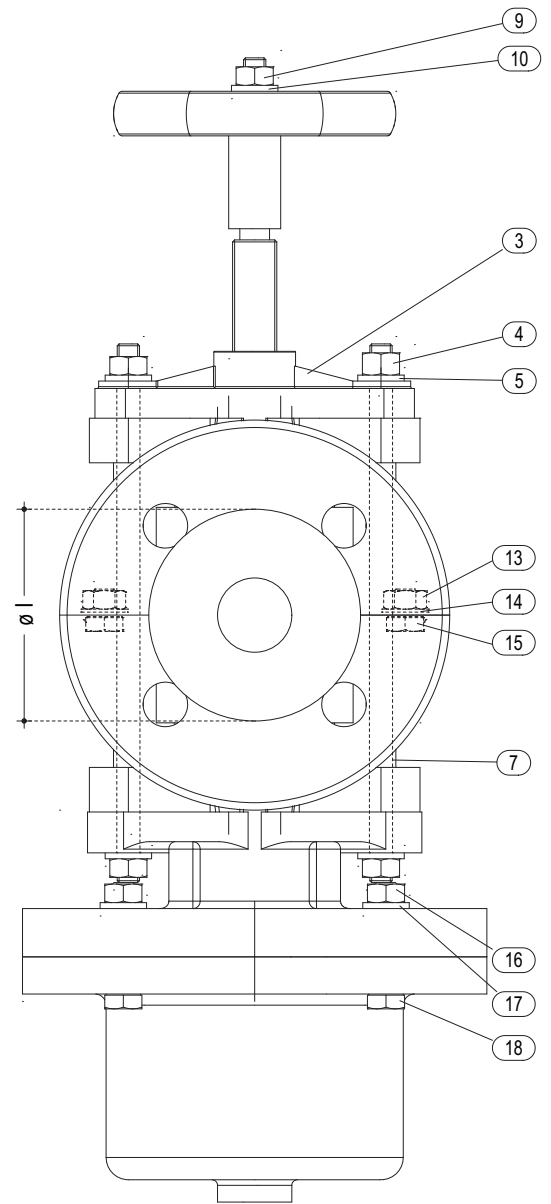
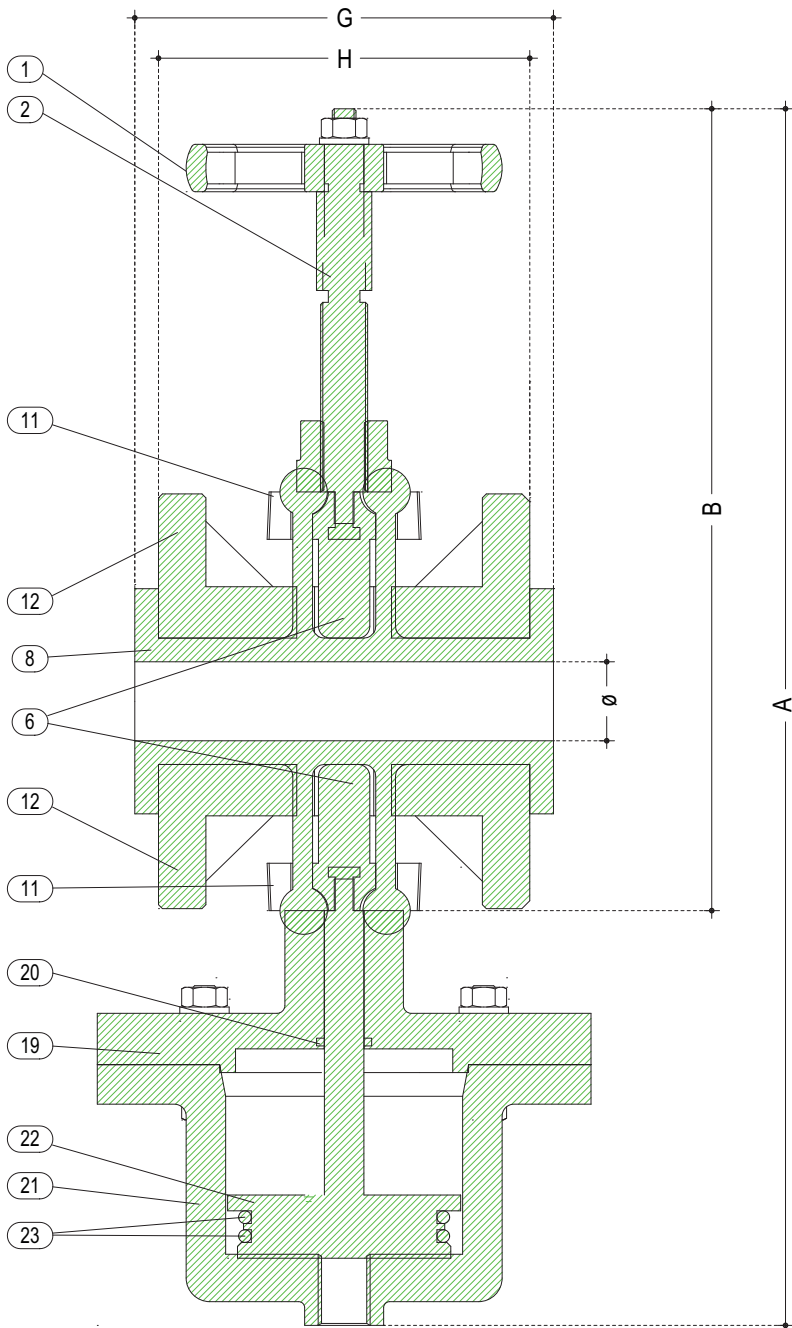

DETAILS

1	WHEEL
2	LEAD SCREW
3	SUPPORT
4	HEXAGON NUT
5	WASHER
6	PLUG
7	TIE ROD
8	RUBBER SLEEVE
9	HEXAGON NUT
10	WASHER
11	RETURN BUSHING BRONZE
12	VALVE BODY
13	HEXAGON NUT
14	WASHER
15	HEXAGON BOLT
16	HEXAGON NUT
17	WASHER
18	HEXAGON NUT SUPPORT AND CYLINDER
19	SUPPORT AND CYLINDER
21	CYLINDER
22	PISTON AND DRIVE PIN
23	"V" GASKET

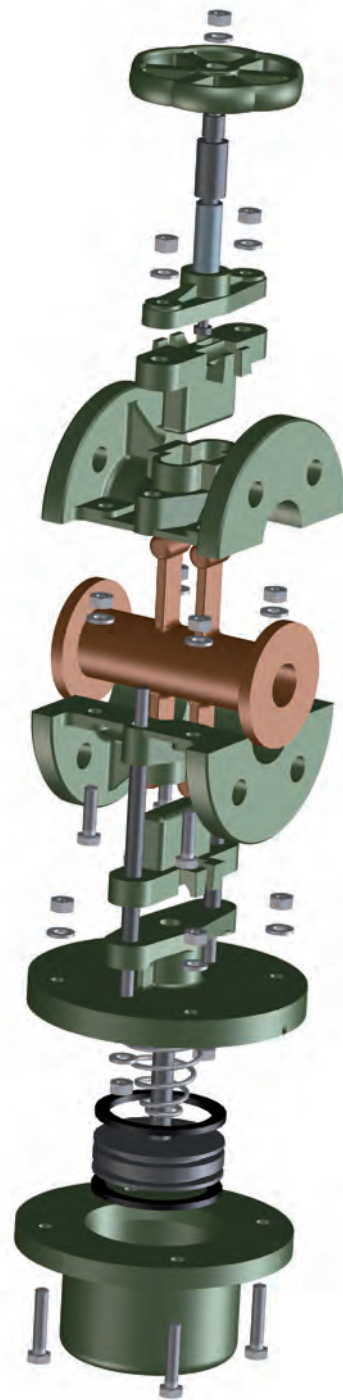
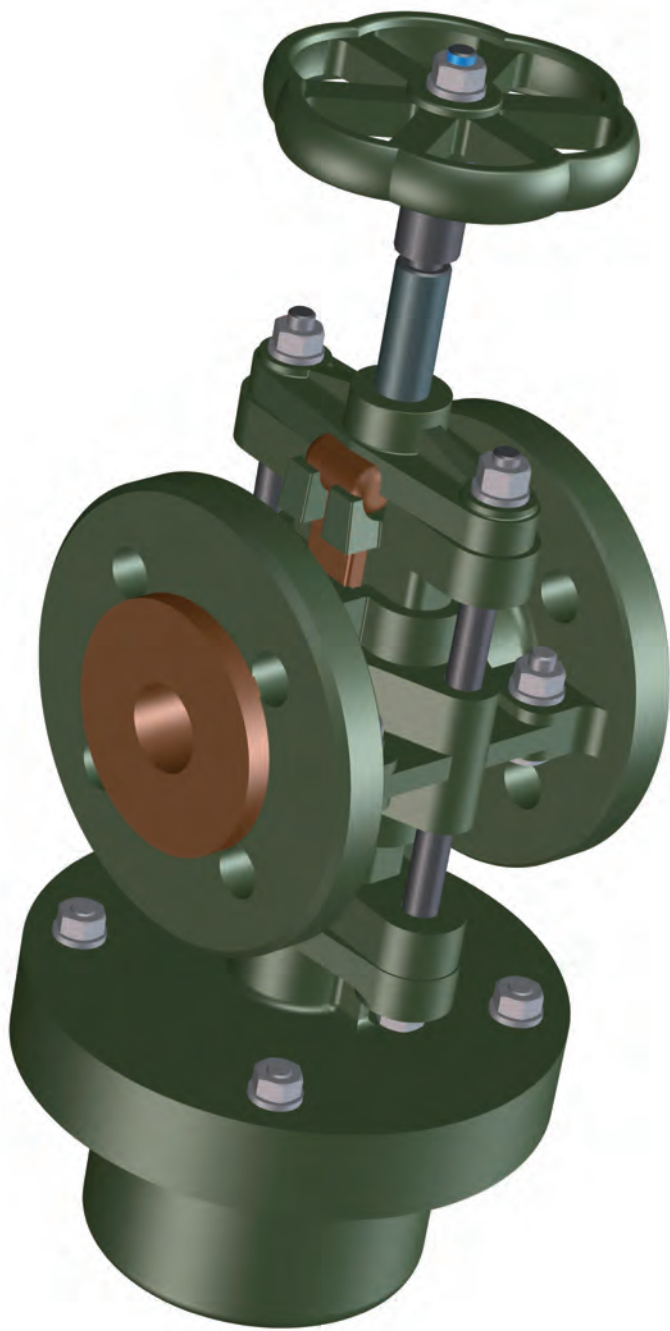

PRESSURE DETAILS UNI_1284

DN	P.N.	HYDRAULIC TEST kg/cm ²		WORKING PRESSURE kg/cm ²
		OPEN	CLOSE	
20	5	10	5	4
25	5	10	5	4
30	5	10	5	4
40	5	10	5	4
50	5	10	5	4
60	5	10	5	4
70	5	10	5	4
80	5	10	5	3
90	5	10	5	3
100	4	10	4	3
125	4	10	4	3
150	4	8	4	3
175	4	8	4	3
200	4	8	4	3

AIR PRESSURE REQUIRED KG/CM²

dn	20	25	30	40	50	60	70	80	90	100	125	150	175	200
min.	4	4	4	4	4	4	4	3,5	3,5	3,5	3,5	3,5	3,5	3,5
max.	6	6	6	5	5	5	5	4,5	4,5	4,5	4,5	4,5	4,5	4,5

WEIGHT KG

ALUMINIUM	C.I.
3,000	5,000
4,500	6,000
5,200	8,000
7,700	12,200
9,000	13,600
12,100	19,000
13,500	21,000
15,000	23,000
23,000	29,000
23,000	36,000
33,000	52,000
43,500	65,000
54,000	79,000
61,000	94,500

DIMENSIONS

Ø	A	B	G	H	I
20	310	205	107	95	58
25	345	220	118	106	68
30	380	245	130	115	78
40	445	300	154	140	88
50	495	330	176	160	102
60	525	350	194	180	130
70	565	280	206	190	137
80	605	410	215	196	148
90	665	450	250	232	178
100	715	490	275	260	158
125	850	600	300	280	198
150	935	650	330	300	222
175	1055	740	355	335	280
200	1142	800	375	350	298

NOTE: For different pressure details please ask the DPT

Model GS6

PINCH VALVES

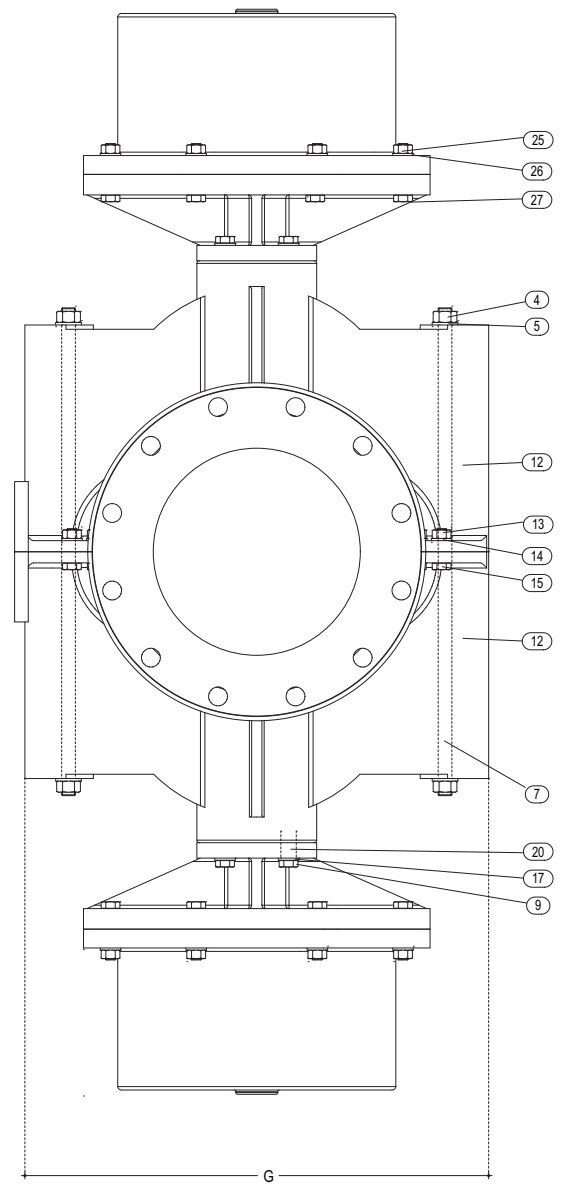
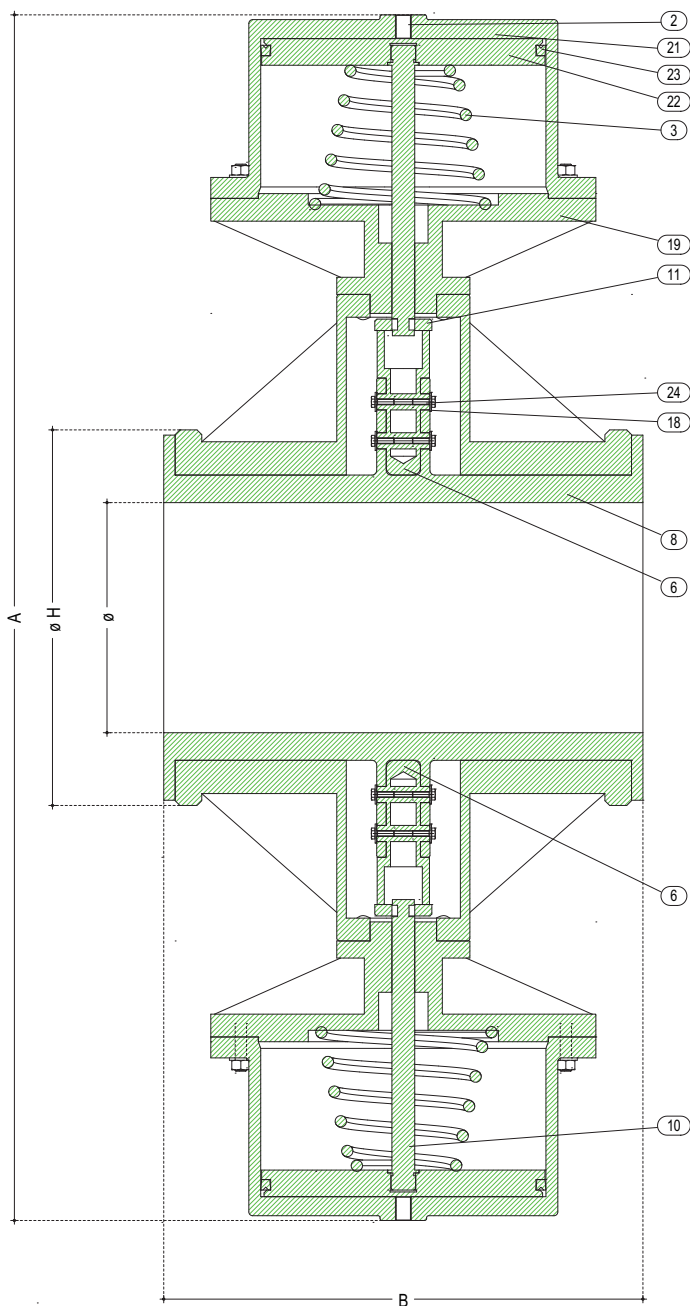

DETAILS

2	INSIDE PIPE FITTING
3	SPRINGS
4	HEXAGON NUT
5	WASHER
6	PLUG
7	TIE ROD
8	RUBBER SLEEVE
9	HEXAGON NUT
10	DRIVE PIN
11	RETURN BUSHING
12	VALVE BODY
13	HEXAGON NUT
14	WASHER
15	HEXAGON BOLT
16	CLAMPING SCREW FOR BUSHING
17	WASHER
18	WASHER
19	SUPPORT AND CYLINDER
20	STUD BOLT
21	CYLINDER
22	PISTON
23	"V" GASKET
24	SCREW
25	HEXAGON NUT
26	WASHER
27	HEXAGON BOLT

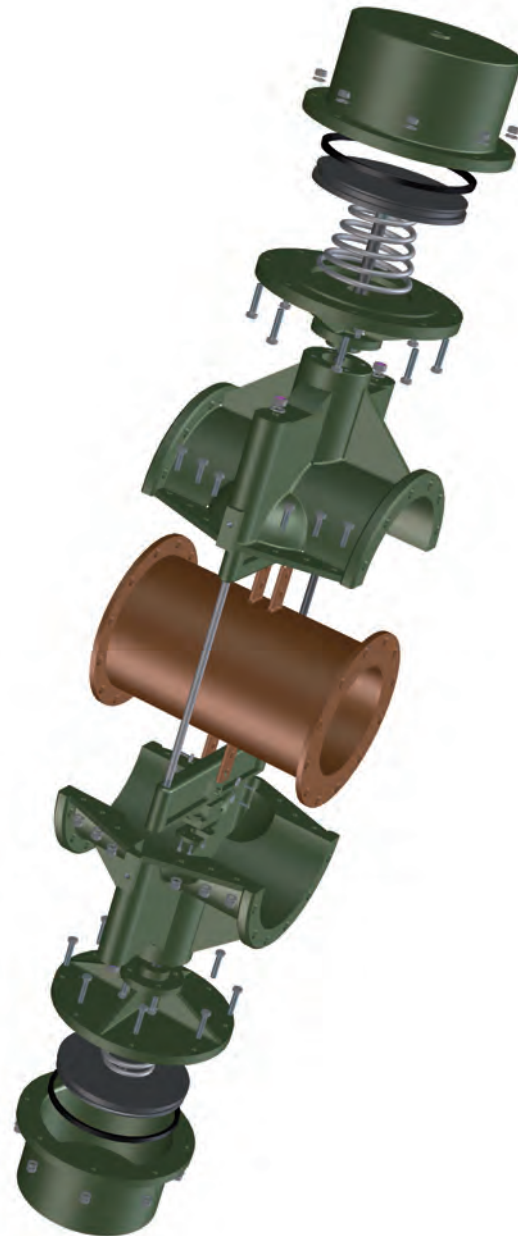

AIR PRESSURE REQUIRED KG/CM²

dn	200	300	350
min.	3,5	3,5	3,5
max.	4,5	4,5	4,5

PRESSURE DETAILS UNI_1284

DN	P.N.	HYDRAULIC TEST kg/cm ²		WORKING PRESSURE kg/cm ²
		OPEN	CLOSE	
250	3	10	3	2
300	2,5	10	2,5	1,5
350	2,5	10	2,5	1,5

WEIGHT KG

ALUMINIUM	C.I.
126,000	211,000
163,000	280,000
205,000	330,000

DIMENSIONS

Ø	A	B	G	H
250	1370	510	515	395
300	1500	600	605	445
350	1655	700	720	505

NOTE: For different pressure details please ask the DPT

Model GS7-7A

PINCH VALVES

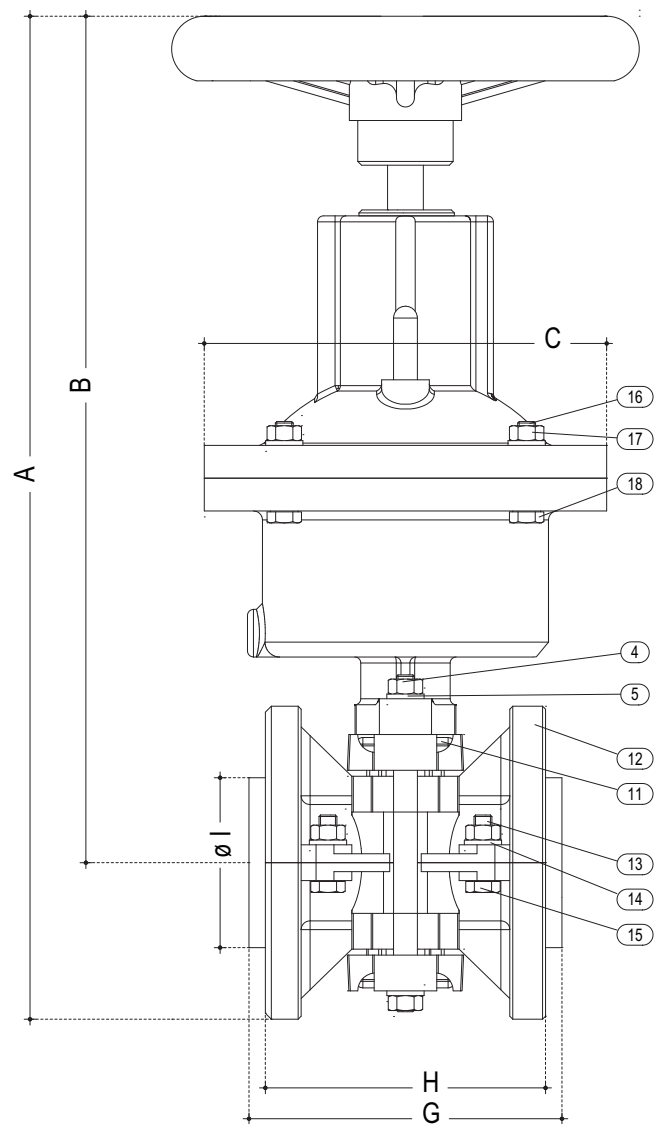
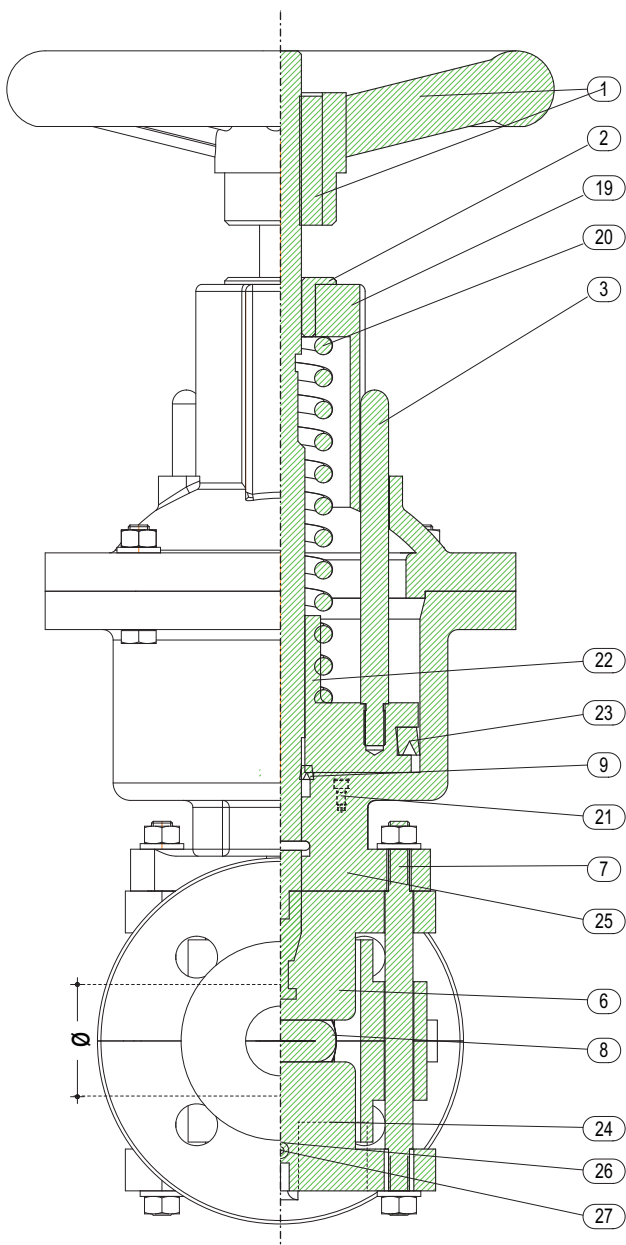

DETAILS

1	WHEEL AND BUSHING
2	SUPPORT RING
3	GUIDE PIN
4	HEXAGON NUT
5	WASHER
6	PLUG
7	TIE ROD
8	RUBBER SLEEVE
9	SMALL "V" GASKET
10	RUBBER TUBE
11	RETURN BUSHING BRONZE
12	VALVE BODY
13	HEXAGON NUT
14	WASHER
15	HEXAGON BOLT
16	HEXAGON NUT
17	WASHER
18	HEXAGON BOLT
19	COVER
20	SPRINGS
21	CYLINDER AND SUPPORT
22	PISTON PIN AND LEAD SCREW
23	"V" GASKET
24	LOWER PLUG
25	CLAMPING SCREW FOR BUSHING
26	WASHER
27	CLAMPING

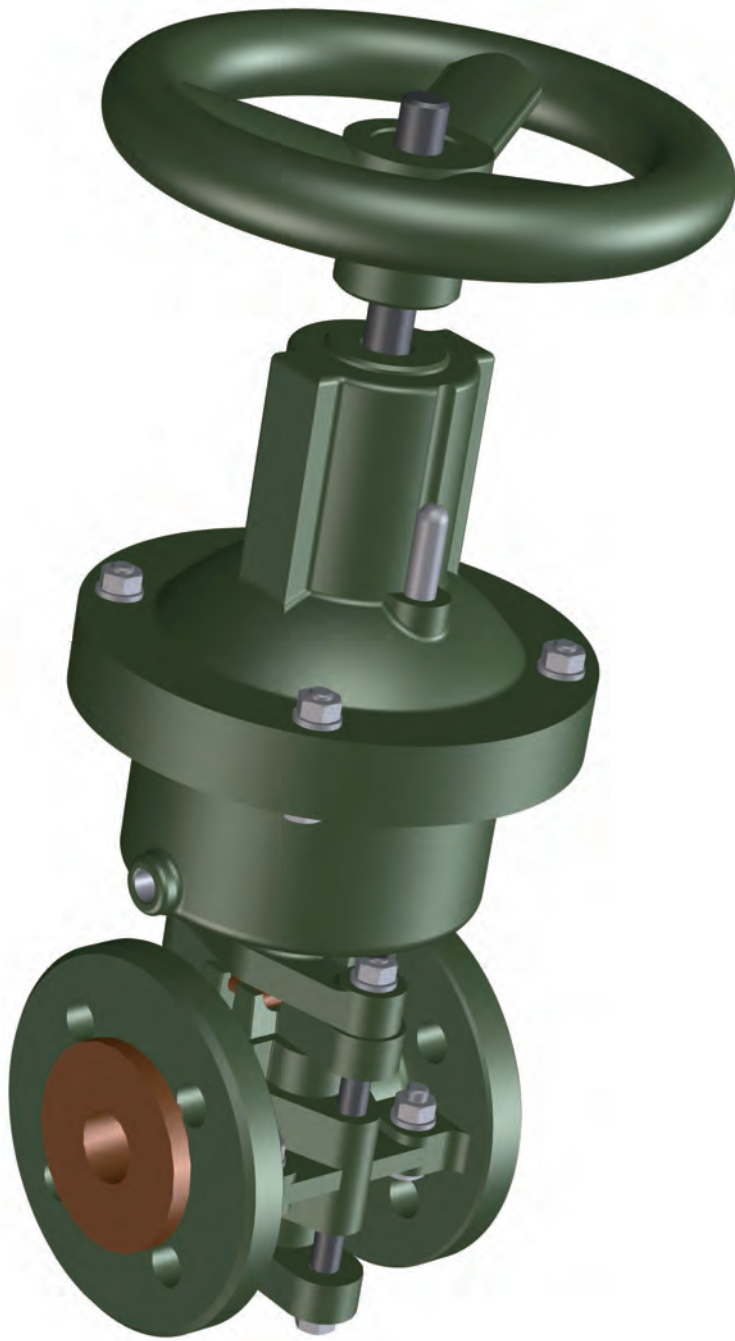

Model GS7

AIR PRESSURE REQUIRED KG/CM²

dn	20	25	30	40	50	60	70	80
min.	4	4	4	4	4	4	4	4
max.	6	6	6	5	5	5	5	5

Model GS7A

AIR PRESSURE REQUIRED KG/CM²

dn	100	125	150	175	200
min.	4	4	4	4	4
max.	6	6	6	6	6

PRESSURE DETAILS UNI_1284

DN	P.N.	HYDRAULIC TEST kg/cm ²		WORKING PRESSURE kg/cm ²
		OPEN	CLOSE	
20	4,5	10	4,5	4
25	4,5	10	4,5	4
30	4,5	10	4,5	4
40	4,5	10	4,5	4
50	4,5	10	4,5	4
60	4	10	5	3
70	4	10	4	3
80	3,5	10	3,5	3
100	3,5	10	3,5	3
125	3,5	10	3,5	3
150	3,5	10	3,5	3
200	3,5	10	3,5	3

WEIGHT KG

ALUMINIUM	C.I.
4,000	5,200
6,500	8,000
8,000	11,000
11,500	15,000
14,000	19,000
18,000	25,000
22,000	28,000
25,000	33,000
32,000	38,000
45,000	54,000
54,000	66,000
81,000	95,000

DIMENSIONS

Ø	A	B	G	H	I
20	355	302,5	107	95	58
25	440	382,5	118	106	68
30	450	380	130	115	78
40	535	460	154	140	88
50	565	482,5	176	160	102
60	600	507,5	194	180	130
70	670	577,5	206	190	137
80	720	620	215	196	148
100	850	740	275	260	158
125	1000	875	300	280	198
150	1200	1058	330	300	222
200	1500	1330	375	350	298

NOTE: For different pressure details please ask the DPT

Model GS8

PINCH VALVES

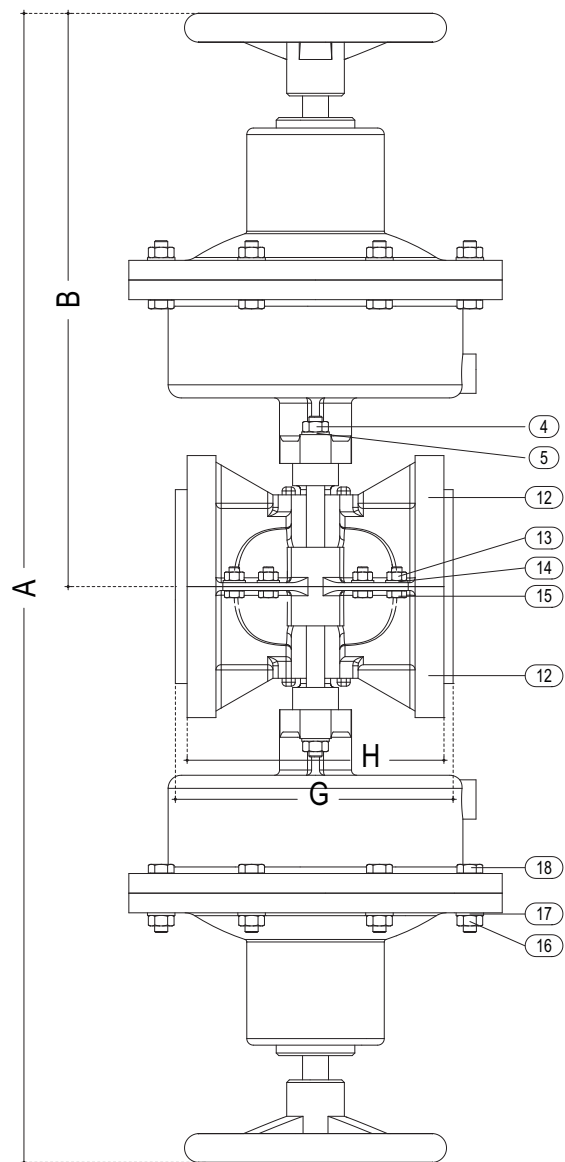
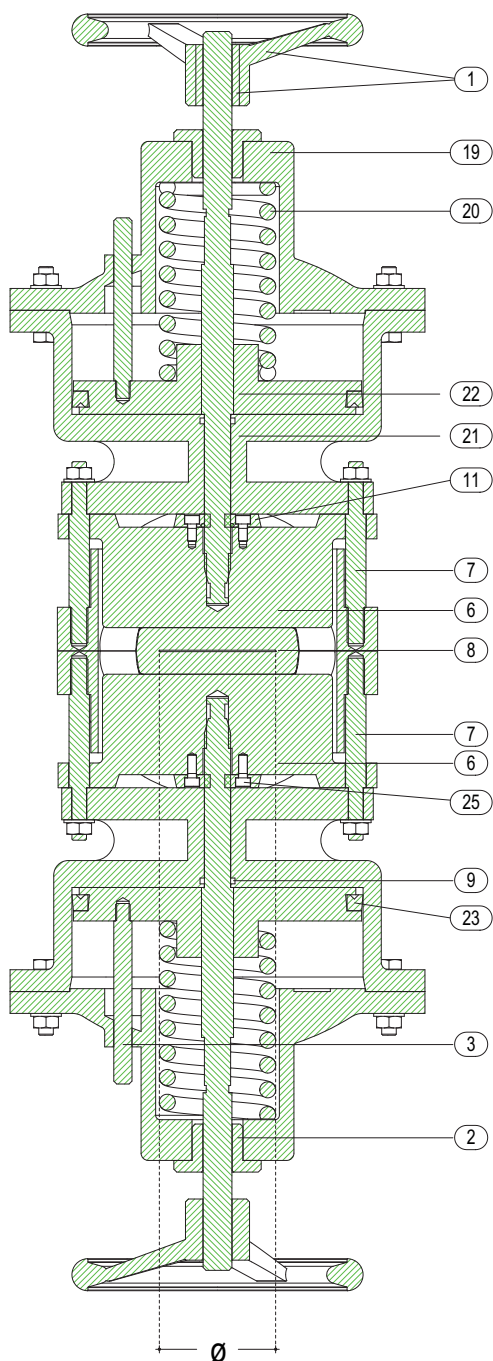

DETAILS

- | | |
|----|----------------------------|
| 1 | WHEEL AND BUSHING |
| 2 | SUPPORT RING |
| 3 | GUIDE PIN |
| 4 | HEXAGON NUT |
| 5 | WASHER |
| 6 | PLUG |
| 7 | TIE ROD |
| 8 | RUBBER SLEEVE |
| 9 | SMALL "V" GASKET |
| 10 | RUBBER TUBE |
| 11 | RETURN BUSHING |
| 12 | VALVE BODY |
| 13 | HEXAGON NUT |
| 14 | WASHER |
| 15 | HEXAGON BOLT |
| 16 | HEXAGON NUT |
| 17 | WASHER |
| 18 | HEXAGON BOLT |
| 19 | COVER |
| 20 | SPRINGS |
| 21 | CYLINDER AND SUPPORT |
| 22 | PISTON PIN AND LEAD SCREW |
| 23 | "V" GASKET |
| 24 | INSIDE PIPE FITTING |
| 25 | CLAMPING SCREW FOR BUSHING |
| 26 | WASHER |
| 27 | CLAMPING |

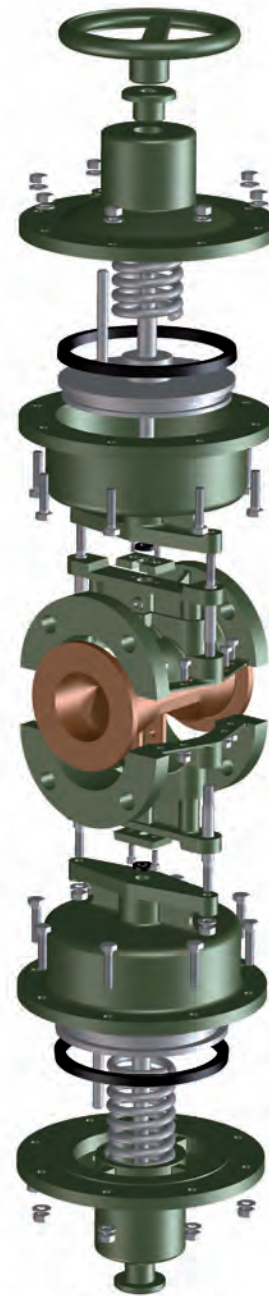
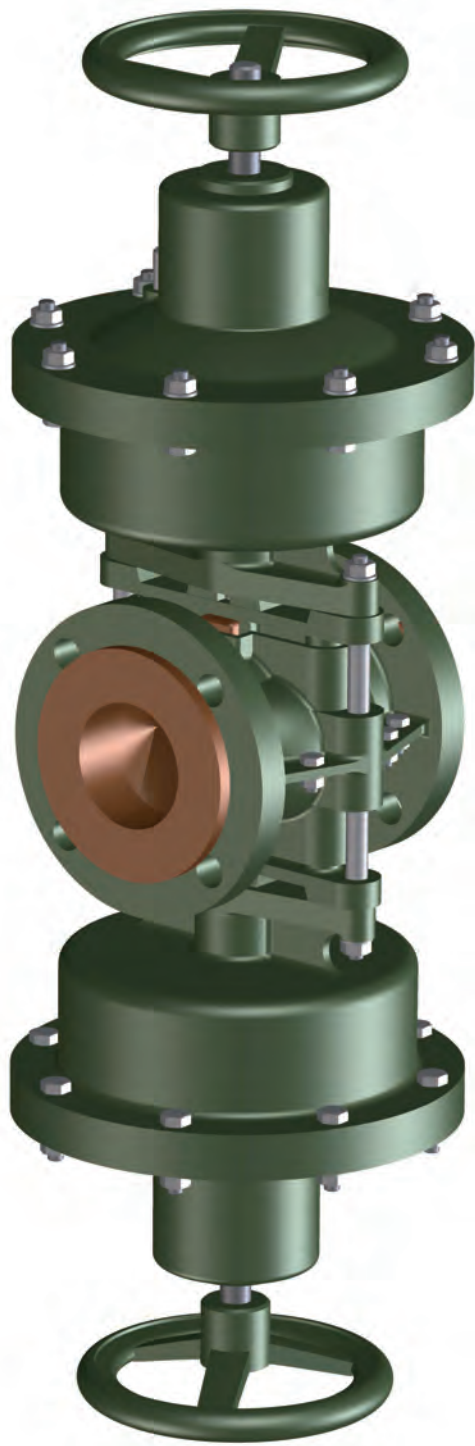

AIR PRESSURE REQUIRED KG/CM²

dn	80	90	100	125	150	175	200
min.	3	3	3,5	3,5	4	4	4
max.	5	5	5	5	5	5	5

PRESSURE DETAILS UNI_1284

DN	P.N.	HYDRAULIC TEST kg/cm ²		WORKING PRESSURE kg/cm ²
		OPEN	CLOSE	
80	3,5	10	3,5	3
90	3,5	10	3,5	3
100	3,5	10	3,5	3
125	3	10	3	2,5
150	3	10	3	2,5
175	2,5	10	2,5	2
200	2	10	2	1,5

WEIGHT KG

ALUMINIUM	C.I.
37,000	47,000
50,000	62,000
49,000	61,000
65,000	80,000
80,500	130,700
91,000	125,000
108,000	163,000

DIMENSIONS

Ø	A	B	G	H
80	940	470	215	196
90	1230	615	250	232
100	1230	615	275	260
125	1290	645	300	280
150	1400	700	330	300
175	1490	745	355	335
200	1550	775	375	350

NOTE: For different pressure details please ask the DPT

Model GS18

PINCH VALVES

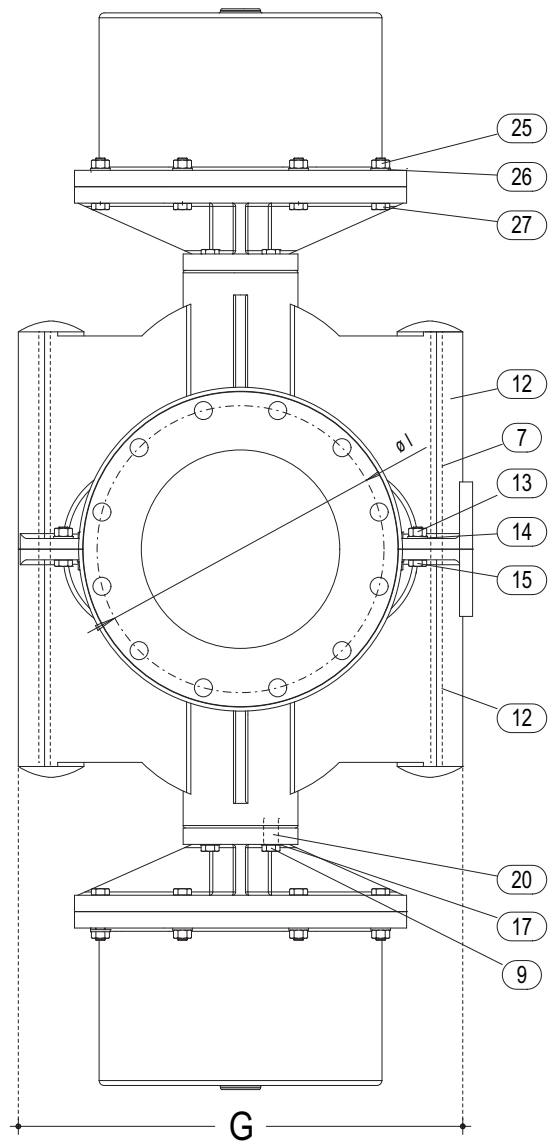
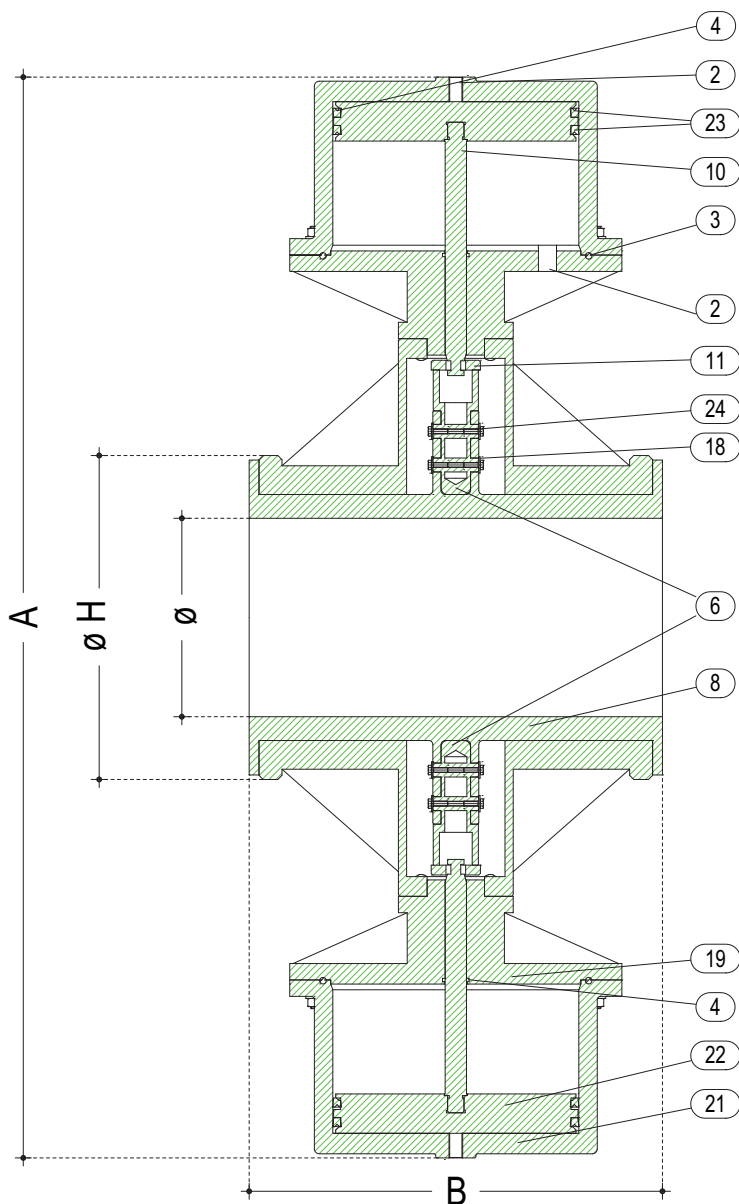

DETAILS

2	INSIDE PIPE FITTING
3	GASKET
4	"V" GASKET
5	RUBBER TUBE
6	PLUG
7	TIE ROD
8	RUBBER SLEEVE
9	HEXAGON NUT
10	DRIVE PIN
11	RETURN BUSHING
12	VALVE BODY
13	HEXAGON NUT
14	WASHER
15	HEXAGON BOLT
16	CLAMPING SCREW FOR BUSHING
17	WASHER
18	WASHER
19	SUPPORT AND CYLINDER
20	STUD BOLT
21	CYLINDER
22	PISTON
23	"V" GASKET
24	CLAMPING
25	HEXAGON NUT
26	WASHER
27	HEXAGON BOLT

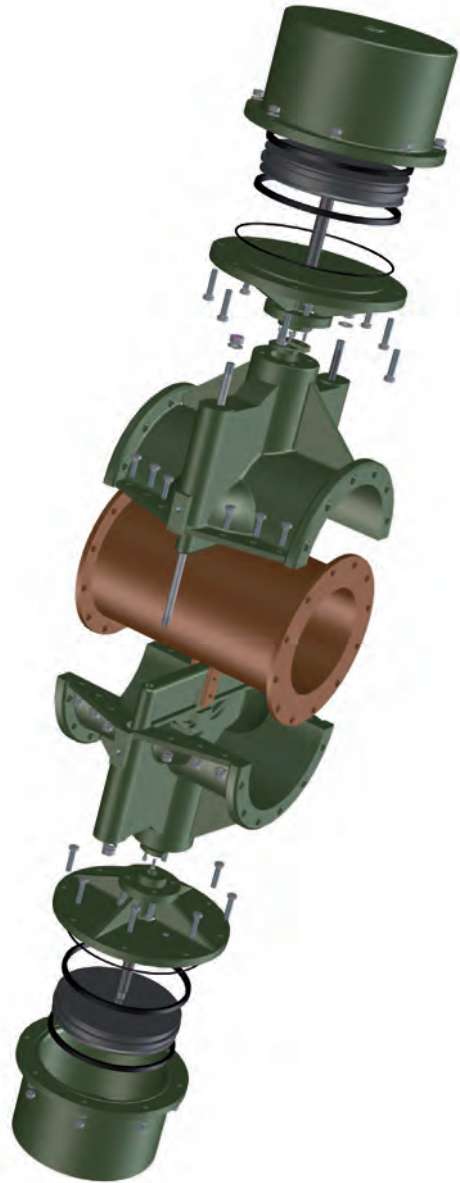
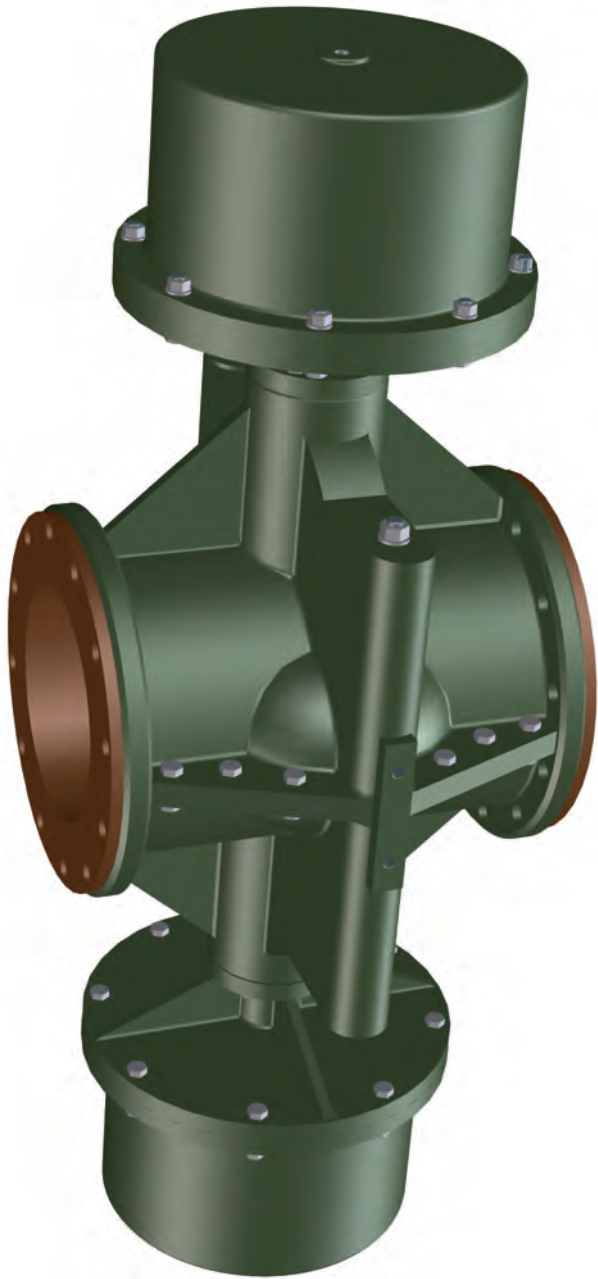

AIR PRESSURE REQUIRED KG/CM²

dn	100	125	150	175	200	250	300	350
min.	3	3	3	3	3	3	3	3
max.	6	6	6	5	5	4	4	4

PRESSURE DETAILS UNI_1284

DN	P.N.	HYDRAULIC TEST kg/cm ²		WORKING PRESSURE kg/cm ²
		OPEN	CLOSE	
100	4	10	4	3
125	4	10	4	3
150	4	8	4	3
175	4	8	4	3
200	4	8	4	3
250	4	8	4	2,5
300	4	8	4	2,5
350	3,5	8	3,5	2

WEIGHT KG

ALUMINIUM	C.I.
44,000	63,000
53,000	76,000
67,000	98,000
84,000	124,000
100,000	154,000
130,000	194,000
160,000	265,000
225,000	365,000

DIMENSIONS

Ø	A	B	G	H	I
100	845	275	282	220	180
125	960	300	328	250	210
150	1055	330	384	285	240
175	1145	355	418	315	270
200	1255	375	460	340	295
250	1400	510	515	395	350
300	1540	600	605	445	400
350	1680	700	720	505	460

NOTE: For different pressure details please ask the DPT

Model GS19

PINCH VALVES

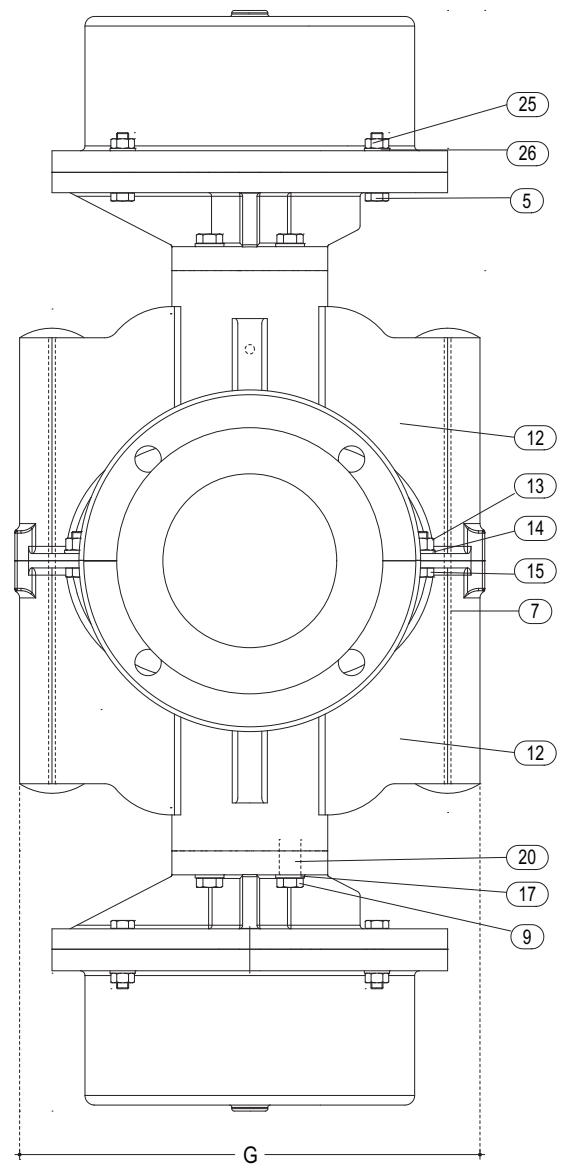
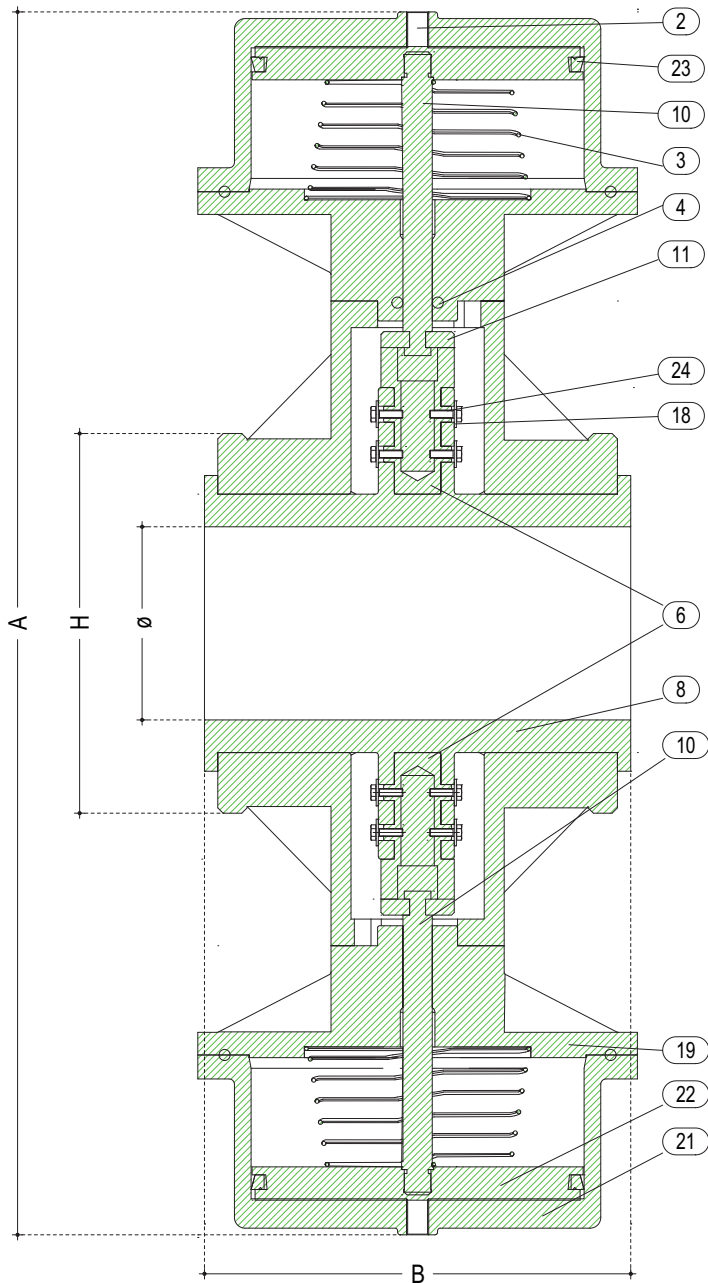

DETAILS

2	INSIDE PIPE FITTING
3	SPRINGS
4	"V" GASKET
5	HEXAGON BOLT
6	PLUG
7	TIE ROD
8	RUBBER SLEEVE
9	HEXAGON NUT
10	DRIVE PIN
11	RETURN BUSHING
12	VALVE BODY
13	HEXAGON NUT
14	WASHER
15	HEXAGON BOLT
16	CLAMPING SCREW FOR BUSHING
17	WASHER
18	WASHER
19	SUPPORT AND CYLINDER
20	STUD BOLT
21	CYLINDER
22	PISTON
23	"V" GASKET
24	SCREW
25	HEXAGON BOLT
26	WASHER

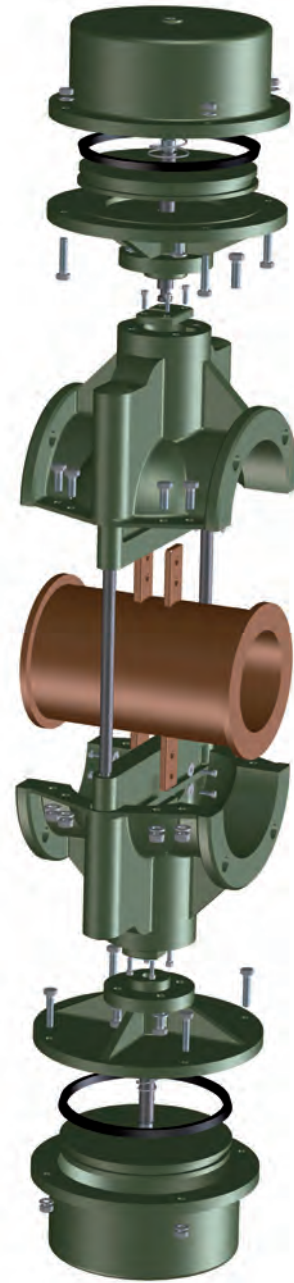
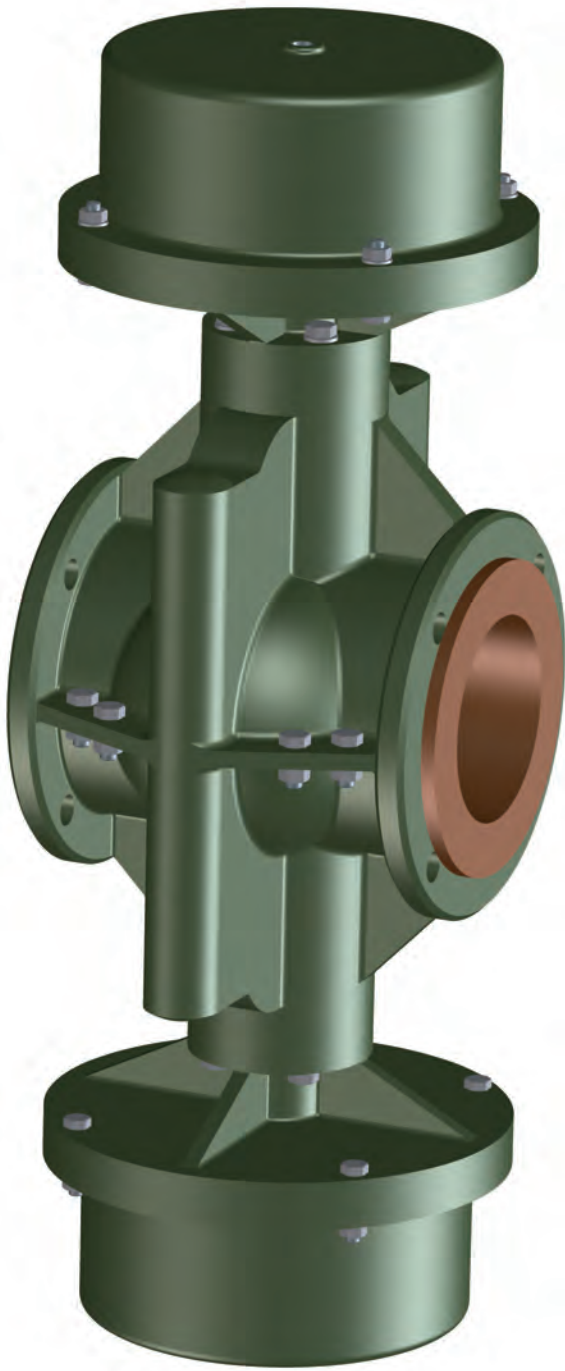

AIR PRESSURE REQUIRED KG/CM²

dn	50	60	70	80	90	100	125	150	175	200
min.	3	3	3	3	3	3	3	3	3	3
max.	6	6	6	6	6	6	6	6	5	5

PRESSURE DETAILS UNI_1284

DN	P.N.	HYDRAULIC TEST kg/cm ²		WORKING PRESSURE kg/cm ²
		OPEN	CLOSE	
50	5	10	5	4
60	5	10	5	4
70	5	10	5	4
80	4,5	10	4,5	3,5
90	4,5	10	4,5	3,5
100	4	10	4	3
125	4	10	4	3
150	4	8	4	3
175	4	8	4	3
200	4	8	4	3

WEIGHT KG

ALUMINIUM	C.I.
17,000	25,000
22,000	32,000
27,000	39,000
35,000	48,000
45,000	60,000
130,000	194,000
51,000	73,000
64,000	95,000
80,000	120,000
96,000	150,000

DIMENSIONS

Ø	A	B	G	H
50	570	176	167	165
60	590	194	190	185
70	660	206	220	185
80	710	215	225	200
90	730	250	282	210
100	800	275	282	220
125	900	300	328	250
150	1020	330	384	285
175	1100	355	418	315
200	1200	375	460	340

NOTE: For different pressure details please ask the DPT

Model GS20

PINCH VALVES

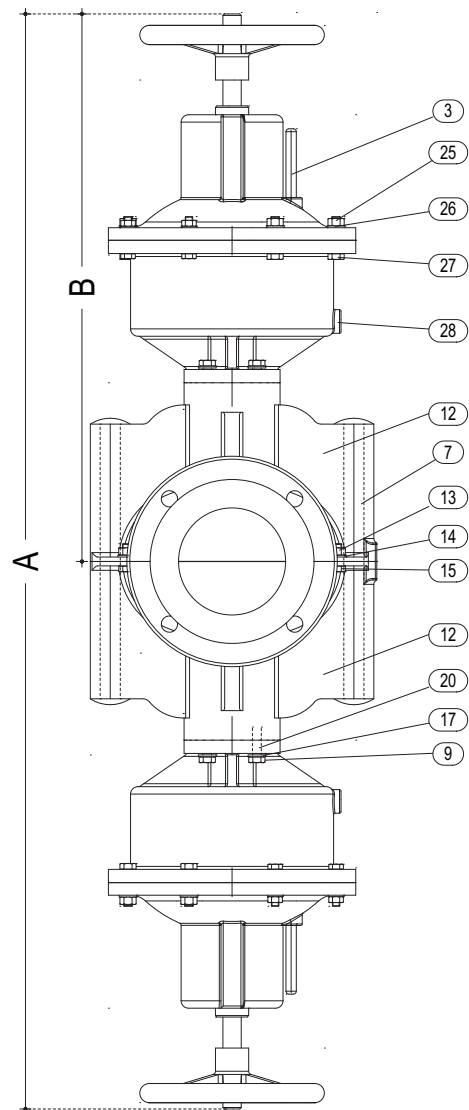
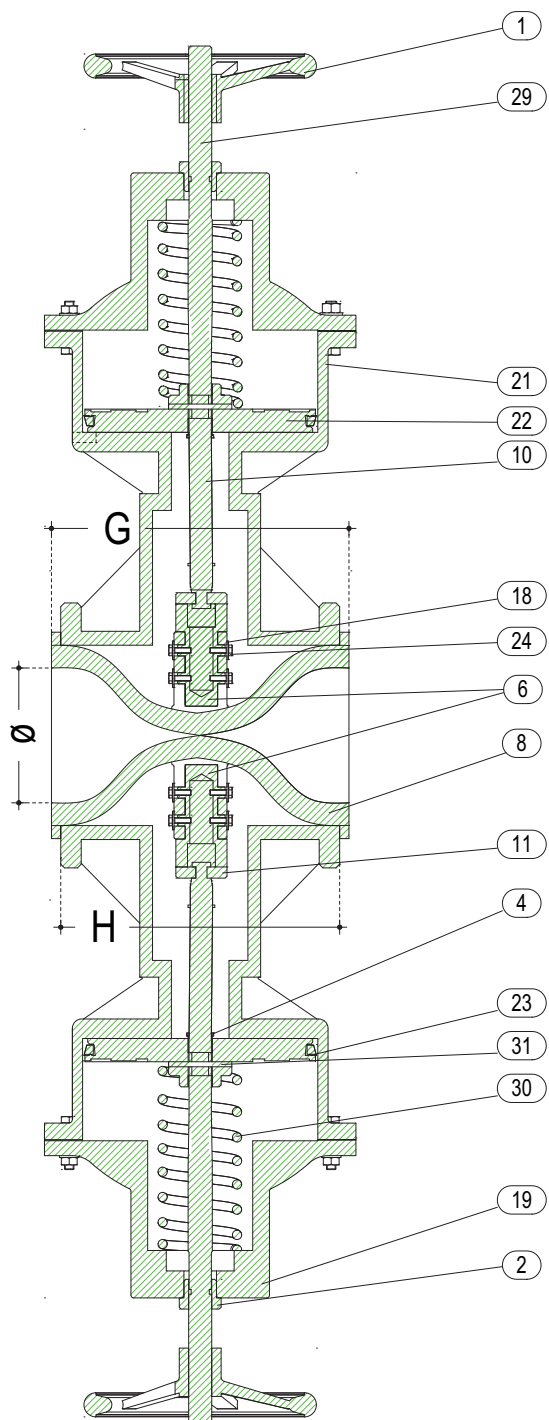

DETAILS

1	WHEEL AND BUSHING
2	SUPPORT RING
3	GUIDE PIN
4	"V" GASKET
6	PLUG
7	TIE ROD
8	RUBBER SLEEVE
9	HEXAGON NUT
10	DRIVE PIN
11	RETURN BUSHING
12	VALVE BODY
13	HEXAGON NUT
14	WASHER
15	HEXAGON BOLT
16	CLAMPING SCREW FOR BUSHING
17	WASHER
18	WASHER
19	COVER
20	STUD BOLT
21	CYLINDER
22	PISTON
23	"V" GASKET
24	CLAMPING
25	HEXAGON NUT
26	WASHER
27	HEXAGON BOLT
28	INSIDE PIPE FITTING
29	LEAD SCREW
30	SPRINGS
31	SOCKET

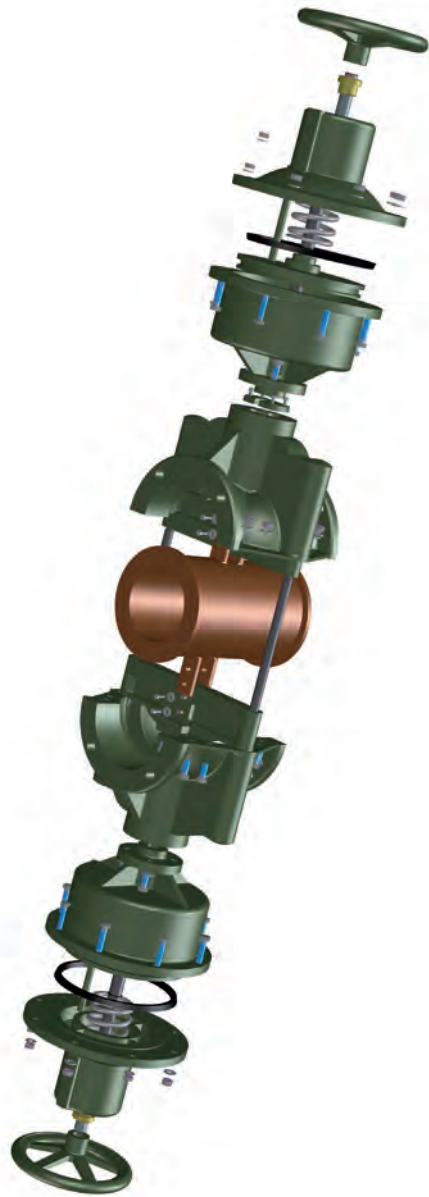
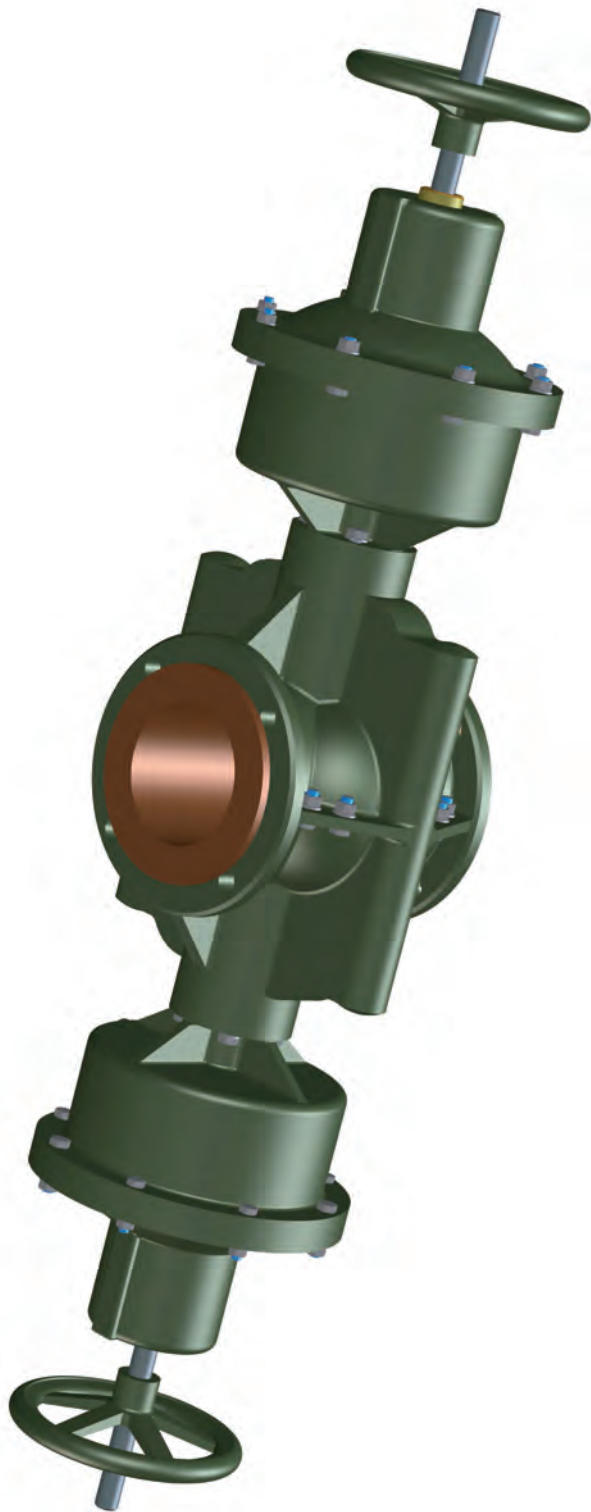

AIR PRESSURE REQUIRED KG/CM²

dn	50	60	70	80	90	100	125	150	175	200
min.	3	3	3	3,5	3,5	3,5	3,5	4	4	4
max.	5	5	5	5	5	5	5	5	5	5

PRESSURE DETAILS UNI_1284

DN	P.N.	HYDRAULIC TEST kg/cm ²		WORKING PRESSURE kg/cm ²
		OPEN	CLOSE	
50	4,5	10	4,5	4
60	4,5	10	4,5	4
70	4	10	4	3,5
80	4	10	4	3,5
90	3,5	10	3,5	3
100	3,5	10	3,5	3
125	3	10	3	2,5
150	3	10	3	2,5
175	2,5	10	2,5	2
200	2	10	2	1,5

WEIGHT KG

ALUMINIUM	C.I.
17,000	25,000
22,000	32,000
27,000	39,000
35,000	48,000
45,000	60,000
130,000	194,000
51,000	73,000
64,000	95,000
80,000	120,000
96,000	150,000

DIMENSIONS

Ø	A	B	G	H
50	800	400	176	160
60	860	430	194	180
70	920	460	206	190
80	980	490	215	196
90	1150	575	250	232
100	1200	600	275	260
125	1300	650	300	280
150	1450	725	330	300
175	1540	770	355	335
200	1780	890	375	350

NOTE: For different pressure details please ask the DPT

Model GS21

PINCH VALVES

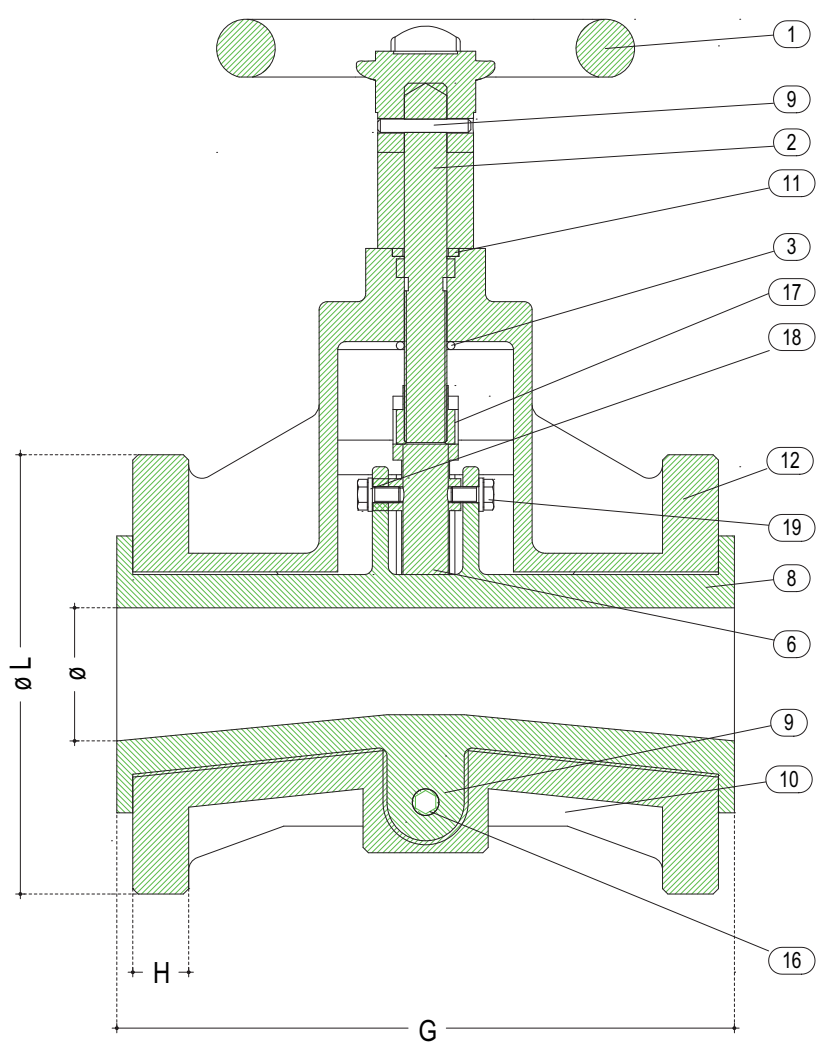
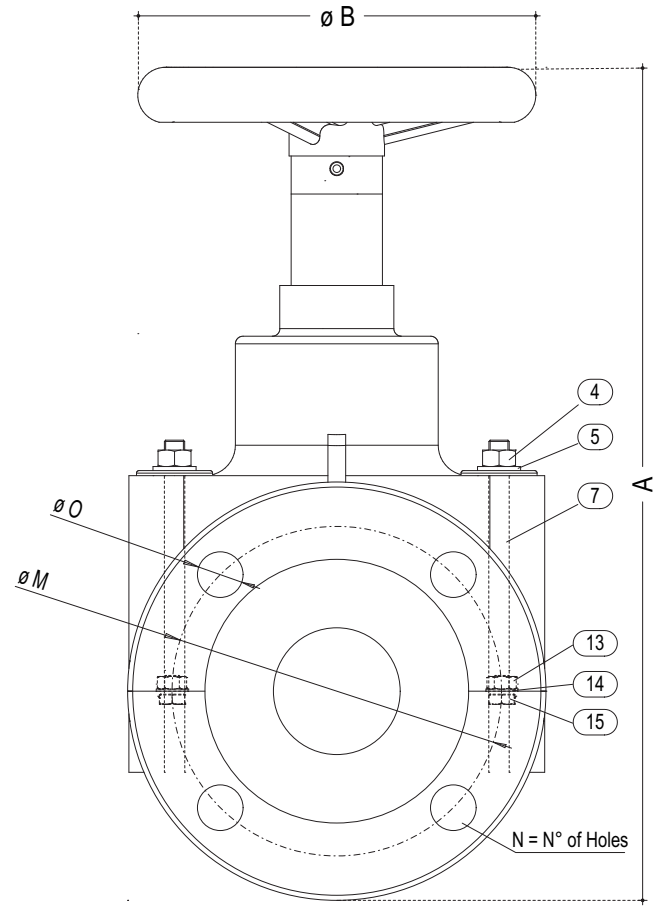

DETAILS

1	WHEEL
2	LEAD SCREW
3	WASHER
4	HEXAGON NUT
5	WASHER
6	PLUG
7	TIE ROD
8	SLEEVE
9	SOCKET
10	VALVE LOWER BODY
11	GASKET
12	VALVE UPPER BODY
13	HEXAGON NUT
14	WASHER
15	HEXAGON BOLT
16	SCREW SOCKET
17	BRONZE NUT
18	WASHER
19	CLAMPING SCREW FOR BUSHING

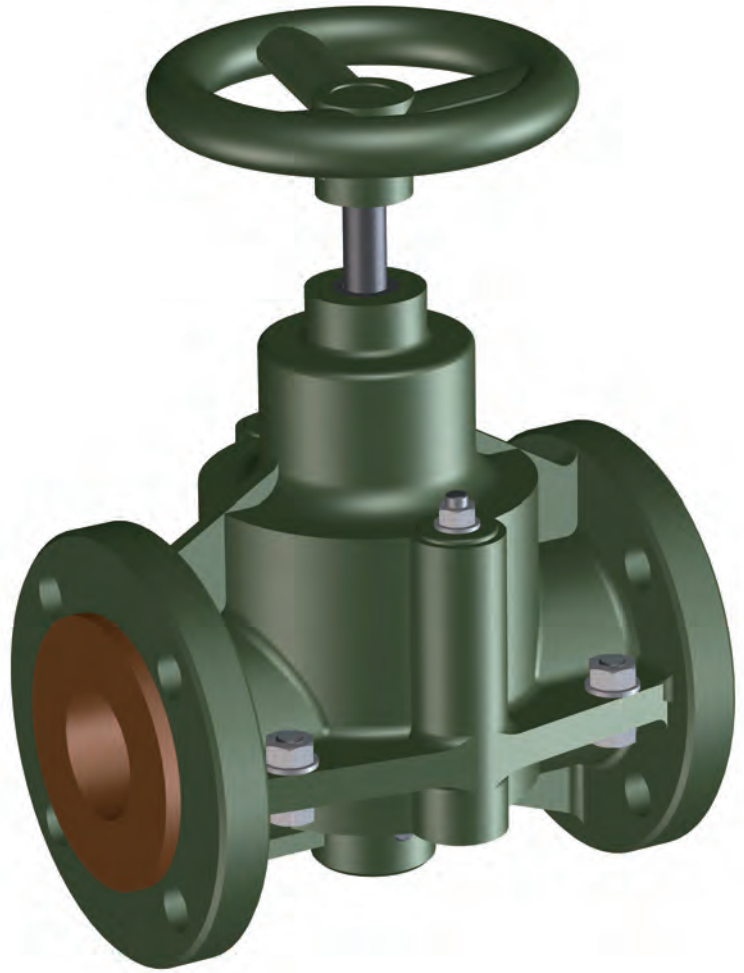
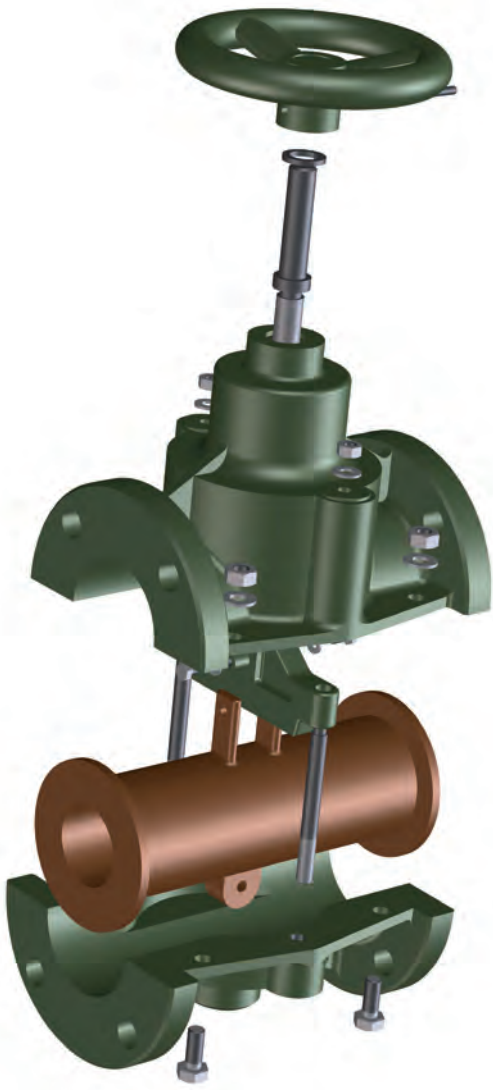

PRESSURE DETAILS UNI_1284

DN	P.N.	HYDRAULIC TEST kg/cm ²		WORKING PRESSURE kg/cm ²
		OPEN	CLOSE	
20	5	10	5	4
25	5	10	5	4
30	5	10	5	4
40	5	10	5	4
50	5	10	5	4
80	5	10	5	4
100	5	10	4	3

NOTE: For different pressure details please ask the DPT

WEIGHT KG ALUMINIUM

2,100
2,380
3,800
5,480
6,900
13,500
19,900
37,000

DIMENSIONS

Ø	DIMENSIONS				UNI PN 10				ASA 150			
	A	B	G	H	L	M	N	O	L	M	N	O
20	185	110	140	14	105	75	4	14	98	70	4	16
25	199	130	150	14	115	85	4	14	108	80	4	16
30	235	130	170	16	140	100	4	18	118	90	4	16
40	267	175	190	18	150	110	4	18	127	98	4	16
50	292	175	220	21	165	125	4	18	152	120	4	19
80	350	210	300	22	200	160	4	18	190	152	4	19
100	425	255	340	22	220	180	8	18	229	190	8	19
150	601	370	470	24	285	240	8	22	280	241	8	22

Model GS22

PINCH VALVES

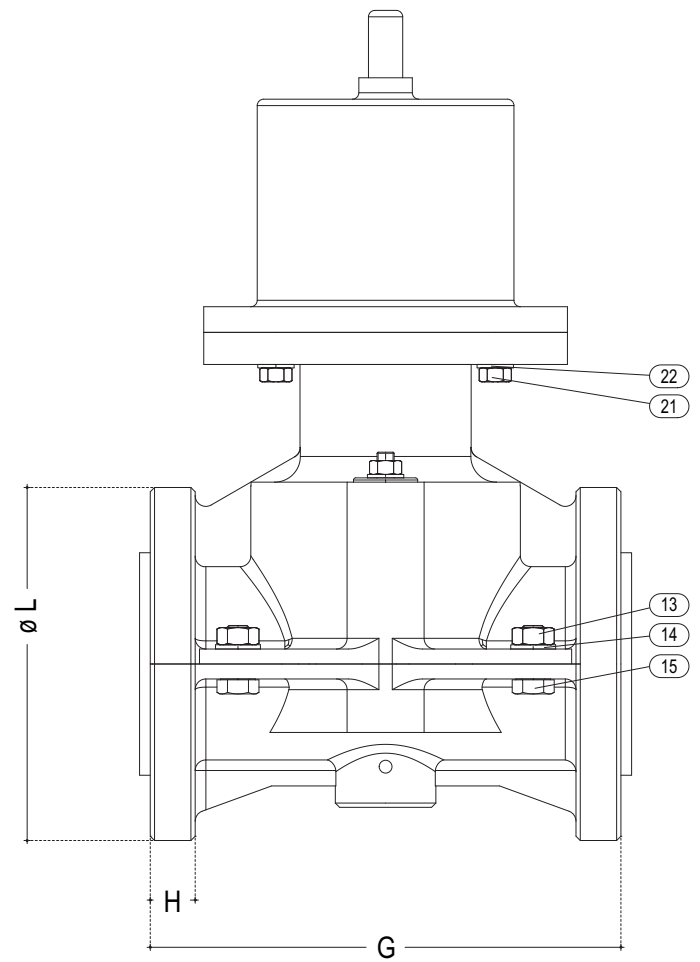
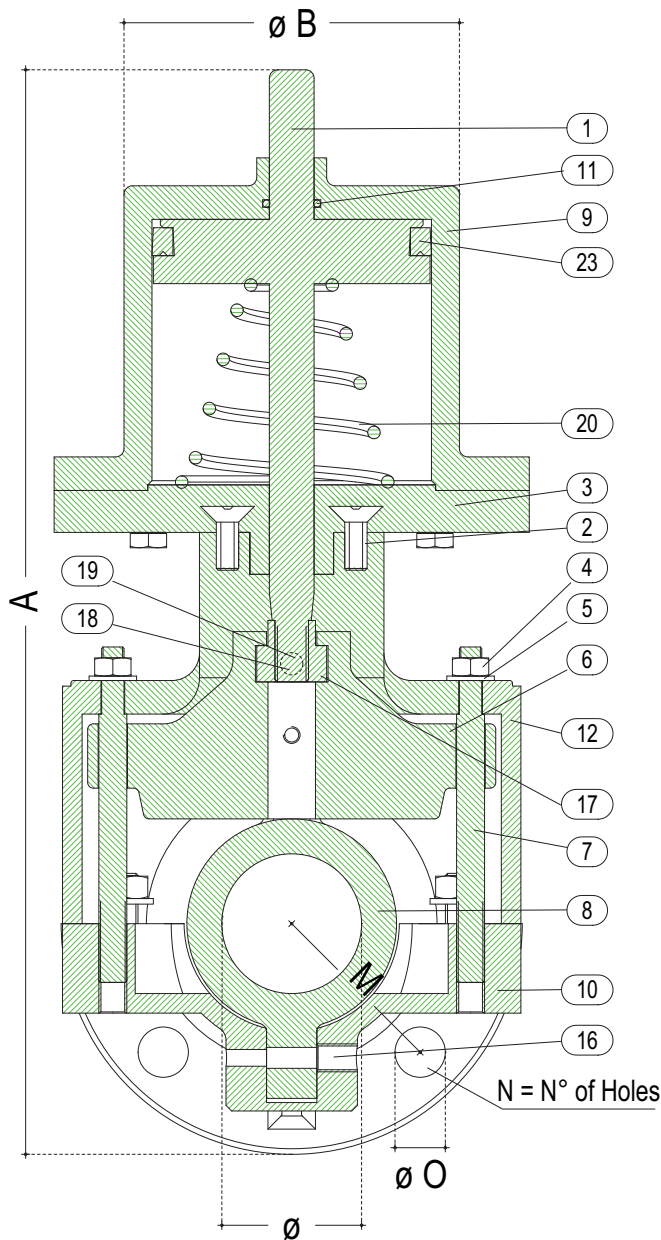

DETAILS

1	DRIVE PIN-PISTON
2	HEXAGON SOCKET HEAD
3	SUPPORT
4	HEXAGON NUT
5	WASHER
6	PLUG
7	TIE ROD
8	SLEEVE
9	CYLINDER
10	VALVE LOWER BODY
11	GASKET
12	VALVE UPPER BODY
13	HEXAGON NUT
14	WASHER
15	HEXAGON BOLT
16	SCREW SOCKET
17	BRONZE NUT
18	WASHER
19	CLAMPING SCREW FOR BUSHING
20	SPRING
21	HEXAGON BOLT
22	WASHER
23	"V" GASKET



PRESSURE DETAILS UNI_1284				
DN	P.N.	HYDRAULIC TEST kg/cm ²		WORKING PRESSURE kg/cm ²
		OPEN	CLOSE	
20	5	10	5	4
25	5	10	5	4
30	5	10	5	4
40	5	10	5	4
50	5	10	5	4
80	5	10	5	4
100	5	10	5	4
150	5	10	5	4

NOTE: For different pressure details please ask the DPT

AIR PRESSURE REQUIRED KG/CM ²								
dn	20	25	30	40	50	80	100	150
min.	4	4	4	4	4	4	4	4
max.	6	6	6	6	6	6	6	6

WEIGHT KG ALUMINIUM
2,300
3,200
4,200
6,000
8,000
14,000
31,000
49,000

DIMENSIONS						UNI PN 10				ASA 150			
Ø	A	B	G	H		L	M	N	O	L	M	N	O
20	240	80	140	14		105	75	4	14	98	70	4	16
25	278	100	150	14		115	85	4	14	108	80	4	16
30	317	100	170	16		140	100	4	18	118	90	4	16
40	366	118	190	18		150	110	4	18	127	98	4	16
50	395	118	220	21		165	125	4	18	152	120	4	19
80	482	145	300	22		200	160	4	18	190	152	4	19
100	698	162	340	22		220	180	8	18	229	190	8	19
150	866	220	470	20		285	240	8	22	280	241	8	22

Model GS25

PINCH VALVES

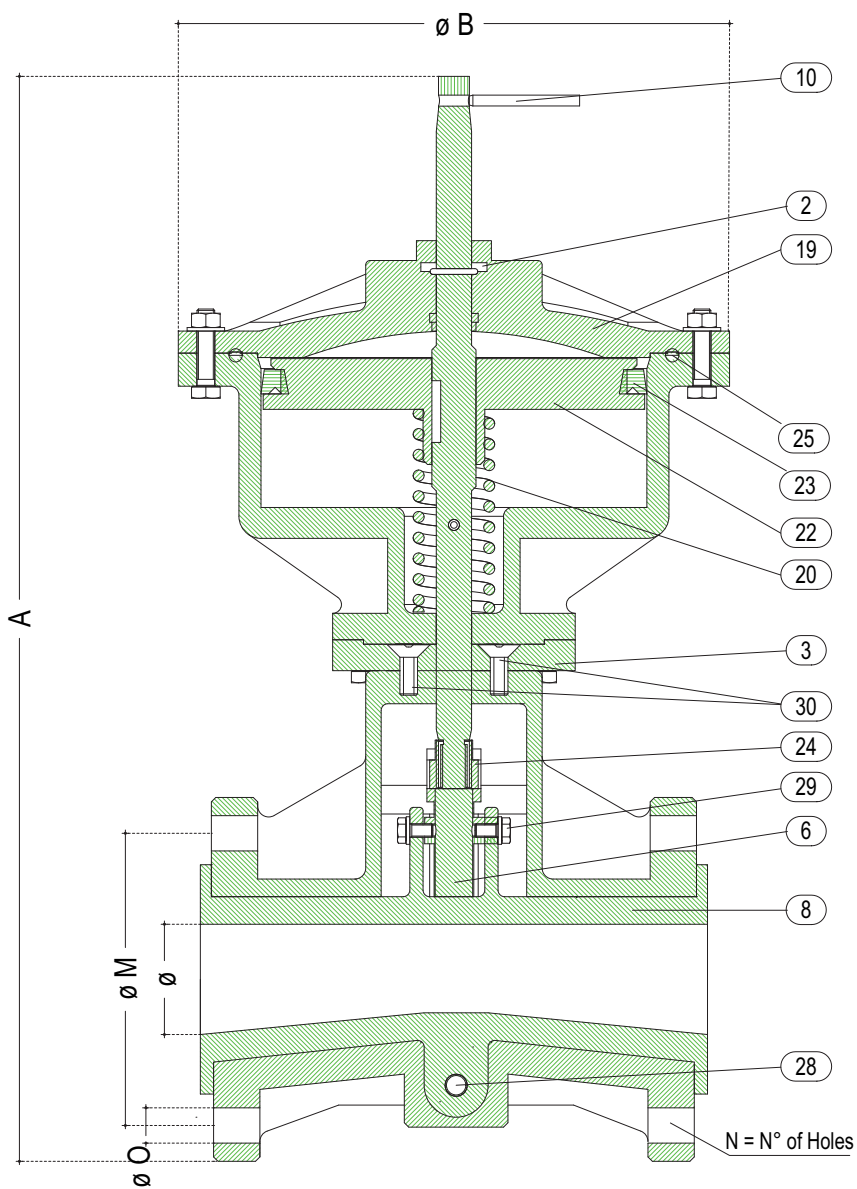
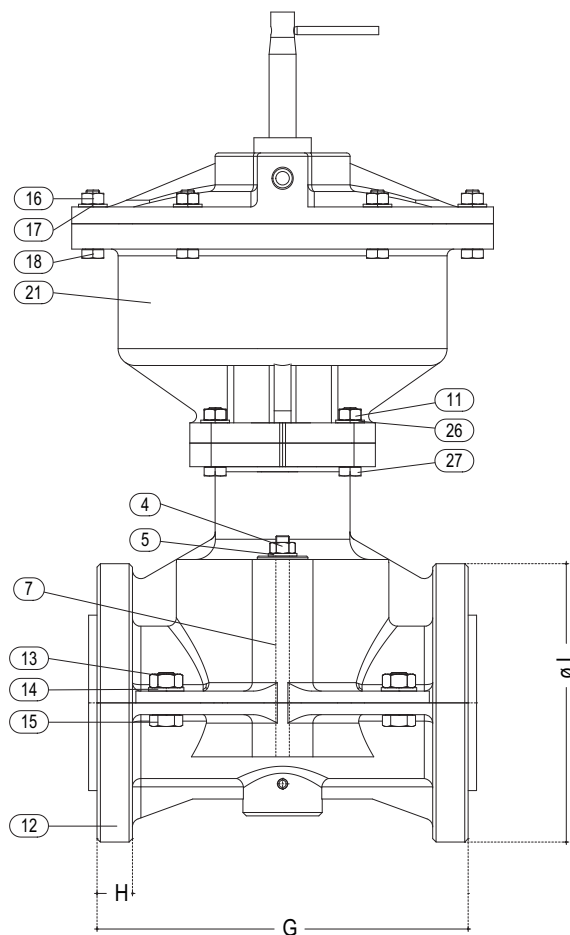

DETAILS

1	GUIDE
2	"V" GASKET
3	SUPPORT
4	HEXAGON NUT
5	WASHER
6	PLUG
7	TIE ROD
8	SLEEVE
9	CLAMPING
10	SOCKET
11	HEXAGON NUT
12	VALVE UPPER-LOWER BODY
13	HEXAGON NUT
14	WASHER
15	HEXAGON BOLT
16	HEXAGON NUT
17	WASHER
18	HEXAGON BOLT
19	COVER
20	SPRING
21	CYLINDER
22	PISTON
23	"V" GASKET
24	BRONZE NUT
25	GASKET
26	WASHER
27	HEXAGON BOLT
28	SCREW SOCKET
29	CLAMPING SCREW FOR BUSHING AND WASHER
30	HEXAGON SOCKET HEAD



AIR PRESSURE REQUIRED KG/CM²

dn	20	25	30	40	50	80	100
min.	4	4	4	4	4	4	4
max.	6	6	6	5	5	5	5

PRESSURE DETAILS UNI_1284

DN	P.N.	HYDRAULIC TEST kg/cm ²		WORKING PRESSURE kg/cm ²
		OPEN	CLOSE	
20	4	10	4	3,5
25	4	10	4	3,5
30	4	10	4	3,5
40	4	10	4	3,5
50	4	10	4	3,5
80	4	10	4	3,5
100	4	10	4	3,5

NOTE: For different pressure details please ask the DPT

DIMENSIONS					UNI PN 10				ASA 150			
Ø	A	B	G	H	L	M	N	O	L	M	N	O
20	291	180	140	14	105	75	4	14	98	70	4	16
25	324	200	150	14	115	85	4	14	108	80	4	16
30	385	215	170	16	140	100	4	18	118	90	4	16
40	432	250	190	18	150	110	4	18	127	98	4	16
50	492	250	220	21	165	125	4	18	152	120	4	19
80	561	285	300	22	200	160	4	18	190	152	4	19
100	728	335	340	22	220	180	8	18	229	190	8	19

Model GS27

PINCH VALVES

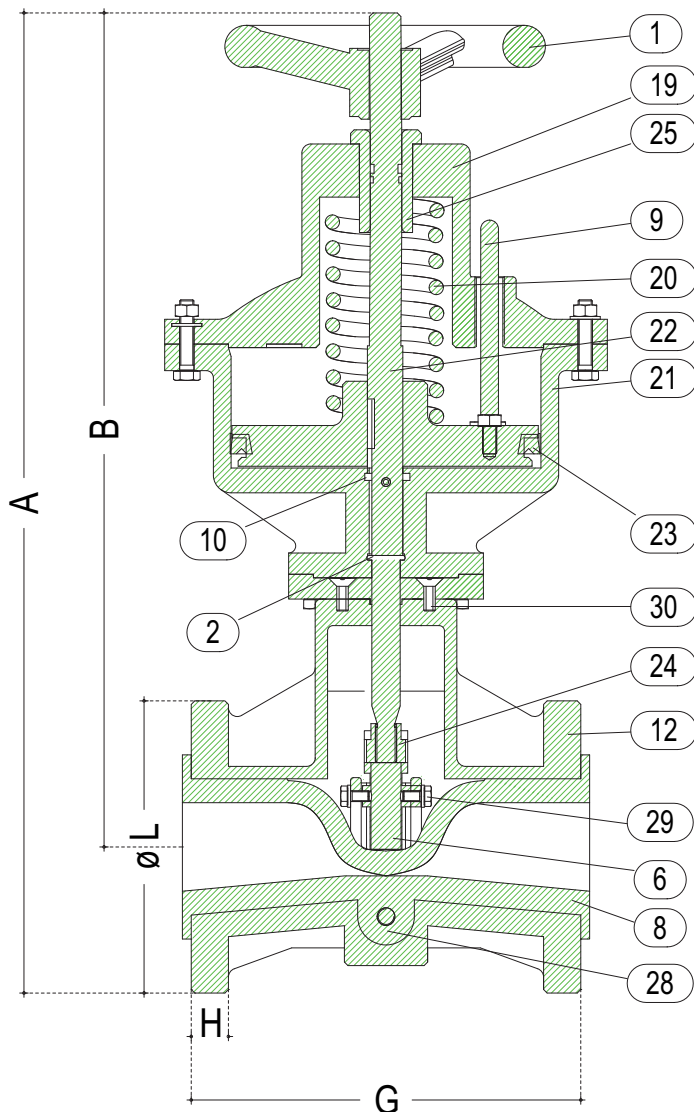
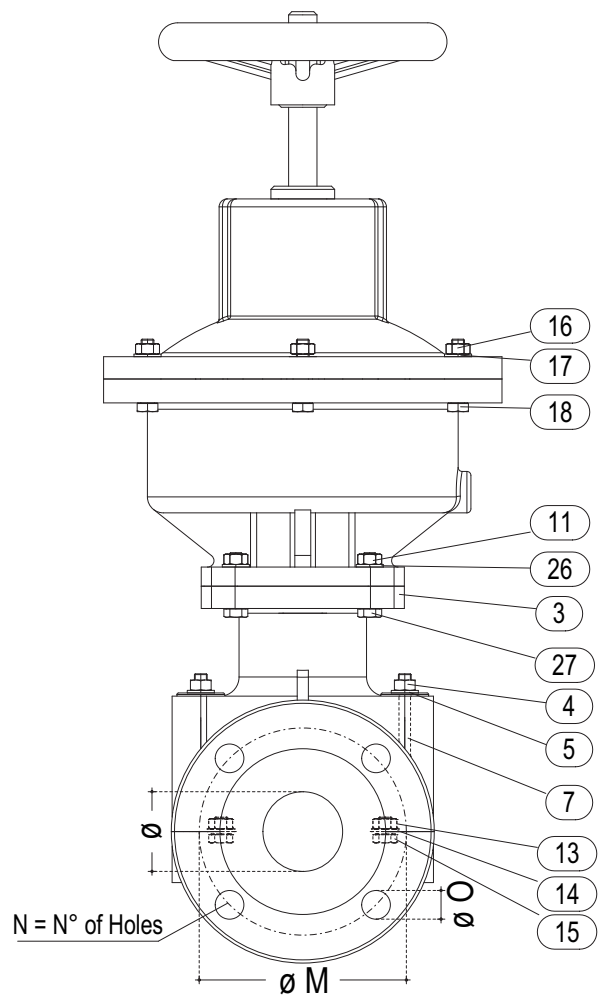

DETAILS

1	WHEEL
2	OR
3	SUPPORT
4	HEXAGON NUT
5	WASHER
6	PLUG
7	TIE ROD
8	SLEEVE
9	GUIDE PIN
10	GASKET
11	HEXAGON NUT
12	VALVE UPPER-LOWER BODY
13	HEXAGON NUT
14	WASHER
15	HEXAGON BOLT
16	HEXAGON NUT
17	WASHER
18	HEXAGON BOLT
19	COVER
20	SPRINGS
21	CYLINDER
22	PISTON
23	"V" GASKET
24	BRONZE NUT
25	BUSHING AND COVER
26	WASHER
27	HEXAGON BOLT
28	SCREW SOCKET
29	CLAMPING SCREW FOR BUSHING AND WASHER
30	HEXAGON SOCKET HEAD COUNTERSUNK HEAD SCREWS



AIR PRESSURE REQUIRED KG/CM ²								
dn	20	25	30	40	50	80	100	150
min.	4	4	4	4	4	4	4	4
max.	6	6	6	5	5	5	5	5

PRESSURE DETAILS UNI_1284				
DN	P.N.	HYDRAULIC TEST kg/cm ²		WORKING PRESSURE kg/cm ²
		OPEN	CLOSE	
20	4	10	4	3
25	4	10	4	3
30	4	10	4	3
40	4	10	4	3
50	4	10	4	3
80	4	10	4	3
100	4	10	4	3
150	4	10	4	3

NOTE: For different pressure details please ask the DPT

DIMENSIONS					UNI PN 10				ASA 150			
Ø	A	B	G	H	L	M	N	O	L	M	N	O
20	389,5	337	140	14	105	75	4	14	98	70	4	16
25	418,5	361	150	14	115	85	4	14	108	80	4	16
30	496	426	170	16	140	100	4	18	118	90	4	16
40	525	450	190	18	150	110	4	18	127	98	4	16
50	535,5	453	220	21	165	125	4	18	152	120	4	19
80	667	567	300	22	200	160	4	18	190	152	4	19
100	812	702	340	22	220	180	8	18	229	190	8	19
150	1130	987	470	24	285	240	8	22	280	241	8	22

Model GS99

PINCH VALVES

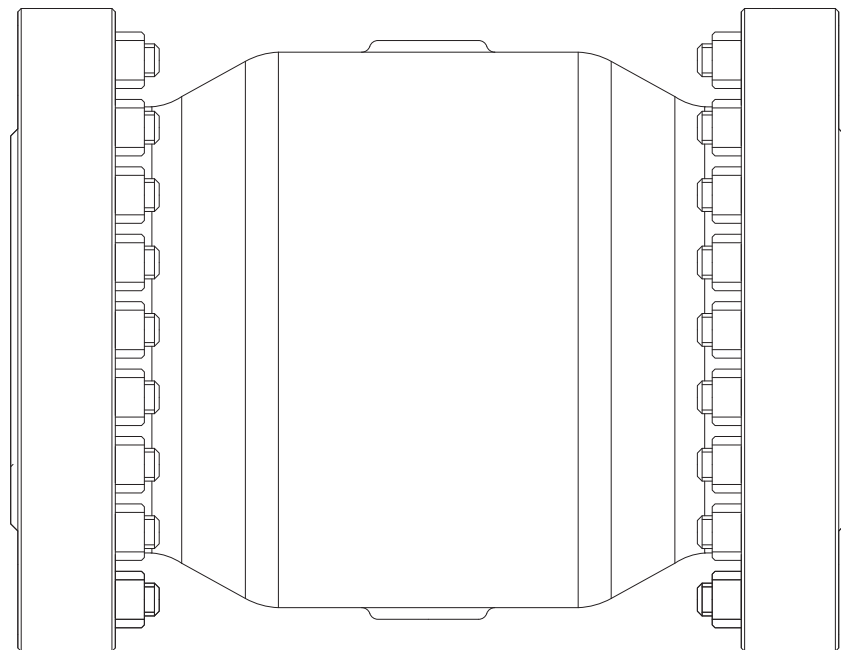
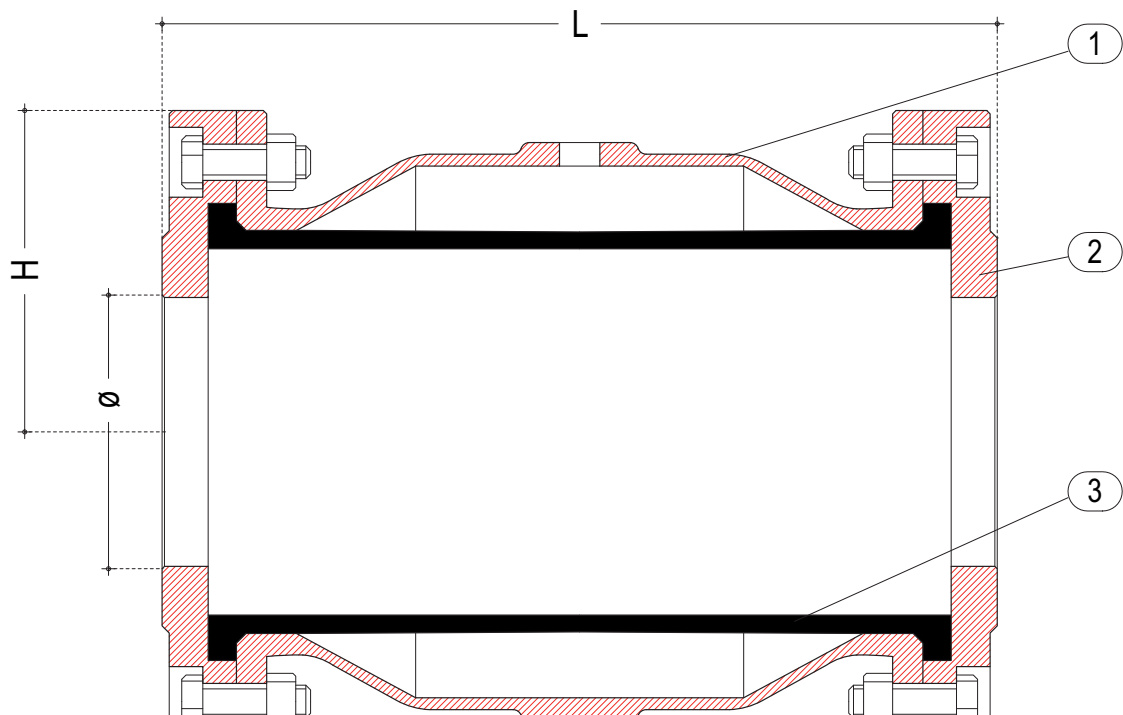

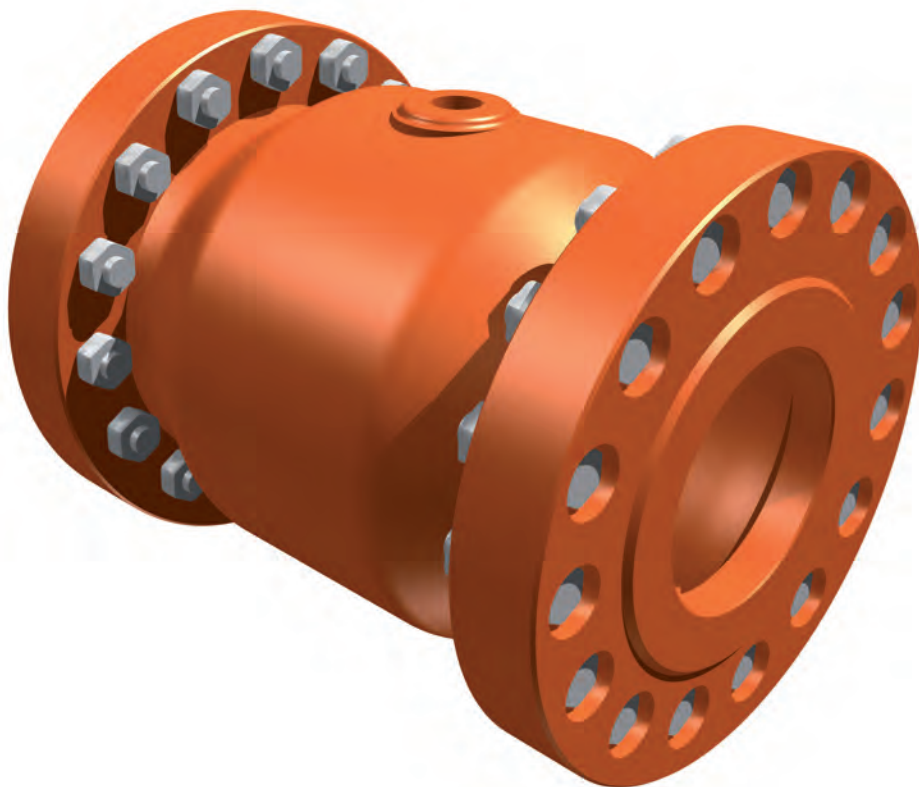

* Dn 20 screwed Type available on request

MAX INTERNAL PRESSURE

4 bar = Dn 40 up to Dn 200
 3 bar = Dn 250 up to Dn 300

CONTROL PRESSURE

Min. 2 Bar = Dn 40 up to Dn 200
 Min. 1,5 Bar = Dn 250 up to Dn 300
 Max. 6 Bar = Dn 40 up to Dn 200
 Max. 4,5 Bar = Dn 250 up to Dn 300

DIFFERENTIAL PRESSURE MIN

2 Bar = Dn 40 up to Dn 200
 1,5 Bar = Dn 250 up to Dn 300

WEIGHT KG

6,00
 8,00
 10,50
 13,00
 12,00
 17,00
 25,00
 53,00
 85,00
 147,00

DIMENSIONS

Ø	L	H
40	150	75
50	180	82,5
65	180	92,5
80	220	100
100	276	110
125	345	125
150	414	143
200	550	170
250	680	195
300	820	242,5

DETAILS

1	BODY
2	FLANGE
3	SLEEVE

Galassi & Ortolani Spa has been making special valves since 1937.

The range of products, comprising:

- diaphragm valves
- pinch valves
- butterfly valves
- check valves
- pneumatic actuators
- ball valves
- gate valves
- thermoplastic valves

is divided into several versions and variants and is used, in particular, in the chemical industry, in water processing and distribution.

The experience achieved during over 75 years in the making of valves for various-nature fluid-management plants has allowed Galassi & Ortolani to make a name in the plant-construction market as a reference producer both at domestic and international level.

ARTISANS OF YEAR 2000

- Uni En ISO 9001 Quality Management System Certified
- Choice of ISO certified suppliers who utilize the latest casting technologies
- Check of all incoming components so as to find and eliminate those defective
- Check of all machined products for conformance to our dimensional standards
- Hydraulic test of body valve at 110/115% of rated pressure to ensure the best tightness
- Each valve being coated with an anti-corrosive varnish at no additional cost

CNC PROCESS

Equipment for Machining Centres and CN Lathes

- To have the utmost control possible on each component
- To allow total interchangeability of each component in case it is changed
- To ensure valve perfect stability and connection
- To reduce Torque rating

CUSTOMER HELP

- Customer's personalized treatment, both pre-sales and after-sales
- Direct intervention by our experts on Plants upon request
- Extensive store of spare parts for immediate availability



CISQ

IONet
THE INTERNATIONAL CERTIFICATION NETWORK

SIMCERT
ACREDITAMENTO ORGANISMO DI CERTIFICAZIONE E ESPERTISE

ISO 9001:2000
Registr. n° IT 44453

GALASSI&ORTOLANI
VALVES MANUFACTURE DIVISION

GALASSI & ORTOLANI SpA
Via Ghirlandaio, 2/4 - 20096 Pioltello (MI) Italy
Tel. +39 02.92103459 - 02.92103801 - 02.92103802 - Fax +39 02.92103804
E-mail: info@galassiortolani.com - www.galassiortolani.com